

SOREN

OWNER'S MANUAL



امداد خودرو فارما

تلفن شبانه روزی: ۰۲۱-۸۸۸۶۲۰۸۵

FarmaSOS.com



SAMAND SOREN

OWNER'S MANUAL

Congratulations on Your Delicate Selection

This manual helps you enjoy driving. Therefore to have an easy access, it would be advisable to be kept in your glove compartment.

The manual is divided into some sections for your convenience, and deals with various aspects of driving or maintenance of the car.

◆ **Before driving:** Includes seat adjustment, Safety belts, heating and ventilation control system and also every other thing you needed to know in order to settle comfortably.

◆ **Driving Controls:** explain functions of switches, equipment and precautions.

◆ **Maintenance:** Includes information about the checks you should carry out regularly.

Technical emergencies: help solve some of unavoidable small emergencies occurring occasionally like replacing lamps fuses or changing wheels.

CAUTION:

Not paying attention to the yellow boxes and CAUTION area tell you about the possibility of an accident, a hazard or a serious hurt if the instructions are not followed carefully.

Caution: This warning symbol warns of potential damages to the car if the recommendations in the text are not followed.

Contents

Before Driving 1

Driving Controls 2

Maintenance 3

Technical Emergencies 4

Technical Data 5

Index 6

امداد خودرو فارما

تلفن شبانه روزی: ۰۲۱-۸۸۸۶۲۰۸۵

FarmaSOS.com

1 -BEFORE DRIVING

Controls
Lock / Unlock
Seats
Seat Belts
Protecting Children
Steering Wheel
Mirrors
Glasses
Heating and Ventilation
Interior Equipment



FarmaSOS.com

1. Gear Lever
2. Heating/Ventilation
3. Clock
4. Airbag System
5. Trunk Lid Unlock Switch
6. Rear Glass Heater /Flasher Switch
7. Windshield Wiper/ Washer Stalk
8. Digital Display Instruments
9. Indicators And Horn
10. Hood Release Lever
11. Adjustable Air Vent
12. Handbrake
13. Audio Equipment(Radio)
14. Audio Equipment(Compact Disc)Mp3
15. Front Ashtray/Lighter
16. Alarm Control Unit (Acu)
17. Ignition Switch
18. Instrument Panel Dimmer Switch
19. Steering Wheel Adjusting Lever
20. Rear Window Locking Switch
21. Electric Window Controls
22. Headlamp Vertical Adjustment
23. Electric Mirror Controls

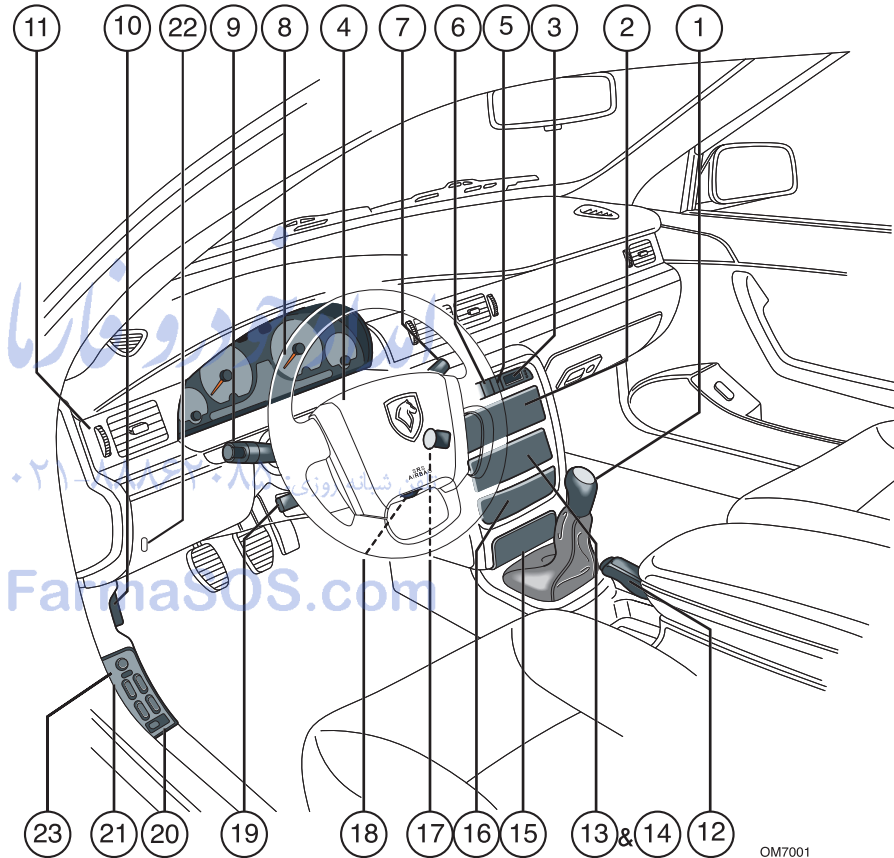

OM7001

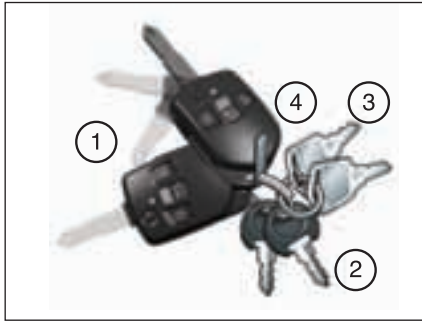

Key Set

Your car is supplied with a key set, which consists of:

- 1- One radio remote control switch (with fixed blade) and a folding switch (Jack knife)
- 2- Two glove box keys
- 3- Two disconnecting alarm switches
- 4- Key identification tag

There is a carved number in the identification tag which is needed in the case of replacing the key. Therefore it should be kept in a safe place and never leave it in the car.

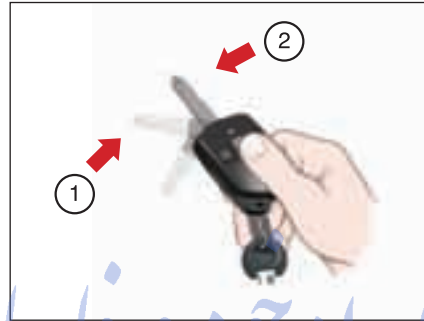

Jack Knife

- 1- Press Jack Knife button. The switch knife will be opened clockwise.
- 2- Move switch blade in a counter-clockwise direction. By holding Jack Knife button put, the knife in its own place.

Radio Central (Door) Locking System

By receiving signals from remote control key, radio transmitter which is located on the front roof console (near map reading lamp), make the radio central (door) locking system operate.

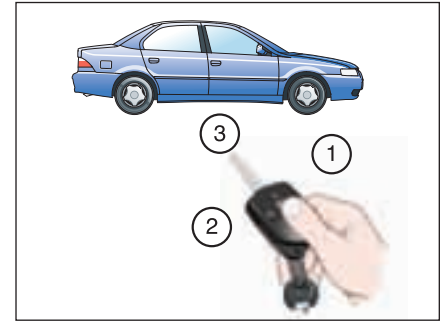

Remote Keyless Entry System

Hold the remote control system in the direction of the vehicle and then press the buttons.

- Press buttons
- (Unlock) Press button "1" to unlock the doors (Theft-Deterrent System is turned off)
- (Lock) Press "2" to lock (Theft-Deterrent system is turned on)

3- Press button "3" to unlock the trunk lid. In each operation, a red light will flash only once showing a signal is being transmitted. When the lock button is activated, all doors, trunk lid and fuel filler cap will be locked. The trunk lid cannot still be accessed by unlocking the button on the remote control switch. The fuel filler cap can be unlocked with the remote central door locking system or turning the key in the front door locks.

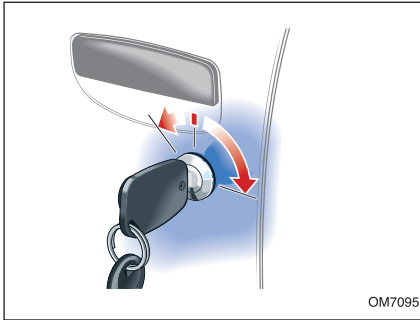

Locking/Unlocking with the Key
Insert the key into the slot near the driver and turn left to unlock and right to lock. All doors, trunk lid and fuel filler cap will be locked.

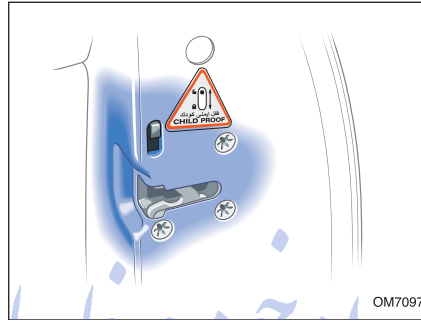

Child Safety Locks

Positioned under the each rear door lock. The child locks prevent the opening of rear doors from the inside and act independent of the central (door) locking system. To latch the children just push the lever down to operate.

FarmaSOS.com

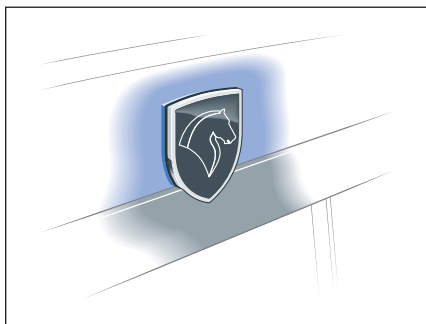

Trunk Lid Lock

Hold the remote control towards the radio transmitter and press the button with the trunk lid symbol (button "3") on the remote keyless entry transmitter in less than a second and twice to open the trunk. When the central door locking system is activated with the remote transmitter or automatic warning locking system, access to luggage compartment is not possible by pressing the trunk lock button. To open the trunk lid, the car should be unlocked by holding remote control button at first (pressing button "1"). To lock: Only by locking trunk, the access to the trunk would be impossible completely.

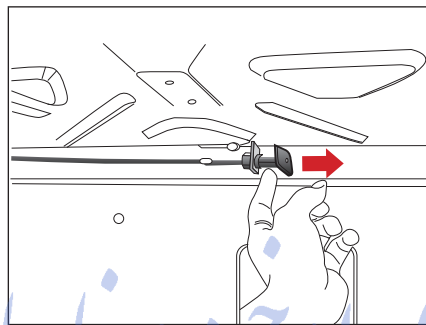

Releasing Trunk Lid Lever and Cable

Pull down on the armrest located at the middle of the rear seat, and release trunk lid latch. Then pull down the latch till it will be placed on the armrest. Take your hand beneath left side of rear shelf. There is a lever and a cable installed –it can be accessed from the interior of the trunk - which will open the trunk in emergency occasions such as lack of internal electricity power, malfunction of trunk lock releasing button on the remote keyless entry system and dashboard. In the above mentioned situations slid the lever to the right.

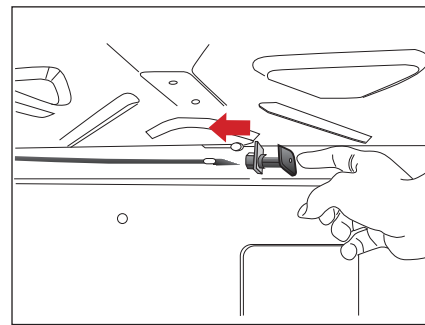

Therefore the trunk will be unlocked mechanically.

To lock well the trunk, please remove the lever after releasing trunk lever and cable mechanisms.



Battery Replacement of the Remote Control Key(Knife Blade)

If the indicator light fails to flash or the switch doesn't work well, then the battery should be changed.

1. Remove the screw with a screwdriver, and remove the switch back cover (normal switch- fixed blade).

Split back and front pieces of the switch, pressing the gap line properly (knife blade) .

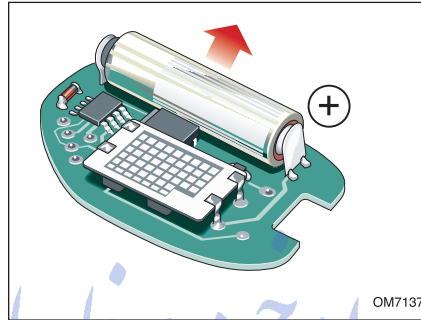

OM7137

2. Remove the exhausted battery and replace it with a new one. Make sure that the new battery is fitted correctly. Use a 27 A/ 12 V battery.

Replace the cover and turn the screw (Normal switch- fixed blade). Press both splits to fix back cover to front pieces.

Note: When the remote control battery goes flat, the central door locking system could still work with the key. Do not use a used auto battery.

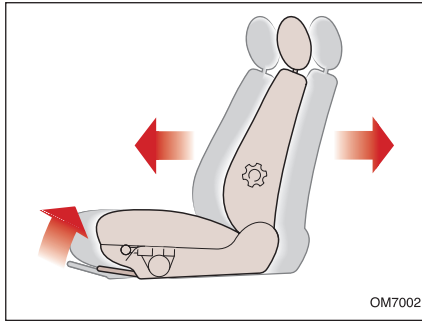

Moving Seat Forward or Backward

Pull up the lever, slide the seat to the favored position (by pressing your weight), and then release the lever till it will be locked. Before driving be sure of adjusting the seat as needed.

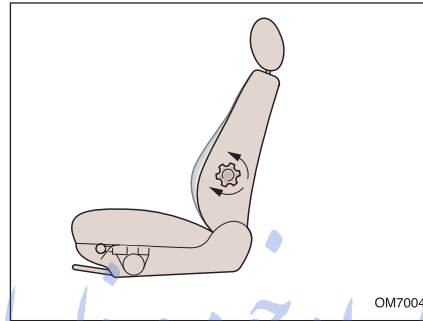

Adjusting Lumbar Support

Rotate the hand wheel to increase or decrease support to the lumbar region of the back.

تلفن شبانه روزی: ۰۲۱-۸۸۸۶۲۰۸۵

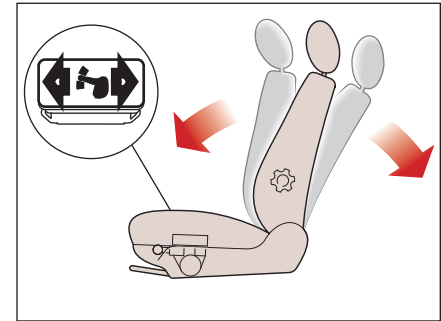

Backrest Power Adjustment

After starting the car with the ignition switch, press the adjustment electrical key beside the seat to adjust the backrest.

Caution: Consider that front passengers should not have their seatbacks reclined if their vehicles are moving. The complete seat belts performance is gained when backrest angle is about 25° from vertical axis.

FarmaSOS.com

Caution: Do not adjust the seat while driving the car

Caution: Consider that front passengers should not run on reclined situation. The complete performance is gained when backrest angle is about 25° from vertical axis.

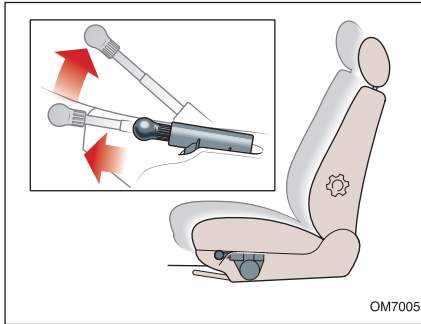

OM7005

Adjusting Seat Height (Driver's Seat Only)

To adjust, sit on the seat and pull out the telescopic lever. Pull up the lever to increase the seat height, and respectively pull down to lower it.

Caution: When pulling down the seat make sure that rear passenger's feet are not beneath the seat.

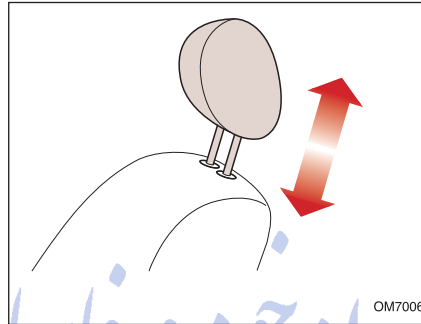

OM7006

Adjusting Headrest Height

To adjust the headrest, lift it up to make it level with your nape. To lower it, pull the seat lever down.

Caution: Considering an extreme force for pulling out the headrest, which in itself may damage the seat, avoid pulling it out except at emergency instances.

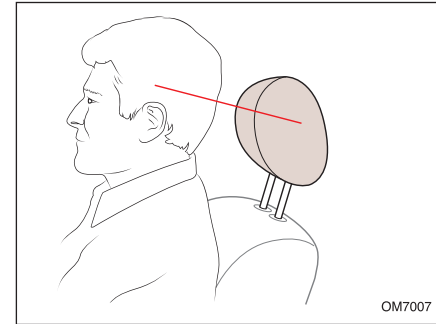

OM7007

Head Position on the Headrest
Headrest is designed to restrain rear movement of the head at event of an accident or a sudden stop. If properly adjusted, a headrest can help reduce the risk of trauma to the neck and head during an accident.

Seat Belts Safety Tips

Seat belts are designed for people of adult size, and they must be used by only one person at a time. Always make sure that all passengers' belts are fastened (properly), and consider the following precautions:

- Do not let passengers recline the seats extremely rearwards. The complete performance is gained when backrest angle is about 25 ° from vertical axis.
 - Adjust safety belts to eliminate any slacks. Do not pull the belt away from the body while running. To operate properly, safety belts should be worn as tightly as possible.
 - The lap part of the belt should not go over the abdomen but pelvic bones. The shoulder belt should go over the shoulder and across the chest without any pressure to the neck.
 - Remove hard, sharp or fragile objects as keys, pens, glasses and etc. from your clothes. The belt should not be twisted, and there would be no obstacle in between.
 - Replace seat belts if they are worn, lost their sensitivity or damaged
 - Use the seat belts to fix luggage carried on the seats. Throwing loose packages in passengers' compartment during an accident can cause serious injuries.
 - In most countries, all passengers are legally obligated to wear safety belts unless be exempted on medical certificate.
 - Pregnant women should pass the shoulder portion across the shoulder, breast cleavage and from one side of the fetus.
- If in doubt, consult your physician.

New Seat Belts

- Equipped with pre-tensioner system to secure occupants in case of happening any probable accidents.
- To reduce the impact of the force posed on the occupant's upper body, it is equipped with force control function system.

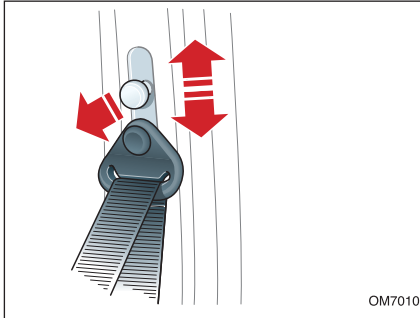

Wearing Safety Belts

Pull the seat belt steadily over the shoulder and across the chest and, ensuring the webbing is not twisted. Insert the latch plate into the appropriate buckle.

A 'click' indicates that the belt is securely locked.

Your vehicle has a safety belt reminder light to remind us about fastening the driver's belt.

After buckling up the drivers' belt, the warning light will be turned off.

Releasing the Belt:

Press the red button on the seat belt buckle.

Caution: DO NOT allow the front passenger to travel with the seat steeply reclined.



Pre-Tensioner System

Press the red button on the belt lock.

The belts are designed to cover the body skeleton (pelvis, chest and shoulders) and are only useful and safe when the seats are almost vertical. Do not allow the front passengers to travel with the seat steeply reclined.

CAUTION: Only a firmly adjusted seat belt can provide a protection. Depending on the severity of the crash, pre-tensioner system operates sooner or simultaneously with the air bag system. In all cases, air bag warning light will be turned on.

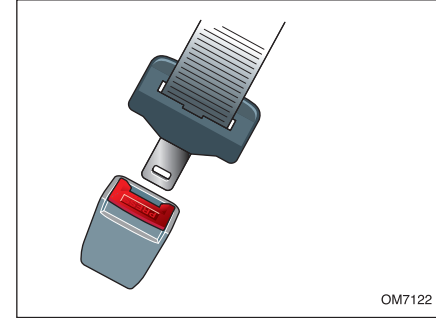

Adjusting Height of Front Seat Belts

To adjust belt height, pull out the height adjusting knob and fix it in some lower or upper level.

Notice: DO NOT let external objects (especially sticky substances) enter seat belt buckles; these items can cause the buckles to be inoperative.

For safety reasons it is advisable that children should use the back seats of the vehicle.

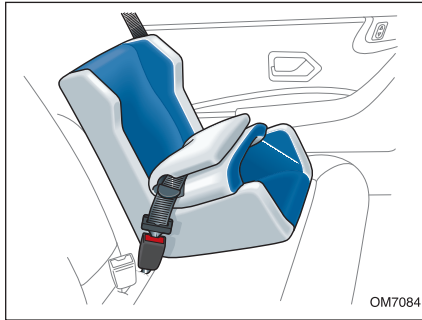

Notice: People under the age of 7 or 8 considered children because of the different ratio of head to body weights. In violent deceleration, the weight of the head and relatively weakness of neck muscle can make serious spinal injuries. They can be considered as young children till reached 10 years of age or at a height of more than 135 centimeters.

This is why most countries have envisaged some rules for the purpose of using and selling suitable child restraints.

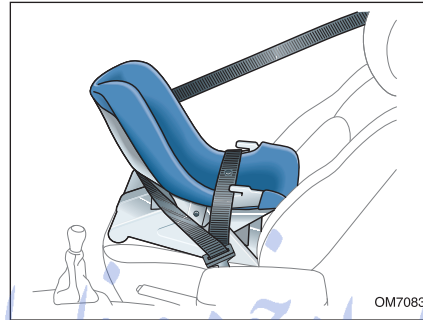

Babies under the 9 months (and less than 10 kg) must be secured on a rear-facing seat in front of the car. Actually infant restraints provide restraint with the seating surface against the back of the car with a three-point belt-seat belt with locking mechanisms (or inertia reel belt).

FarmaSOS.com

The seat of the child from 9 months to 3 years (up to 18 Kg) should be placed forward-facing in the rear of the car and fixed with a three-point belt (lap-and-sash or inertia reel belt).

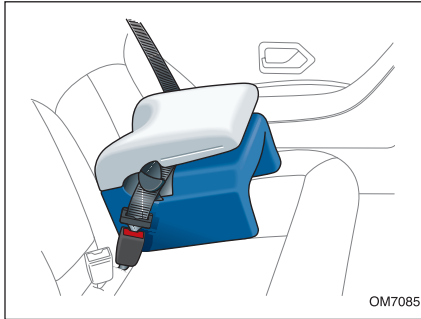

For children (weighing more than 15 kg) equal or greater than 3 years old (more than 15 Kg), a booster seat can be used in the rear of the car, facing forward, using a 2 or 3 point (lap or inertia reel) seat belt (especially suitable for children roughly 3 to 6 years old).

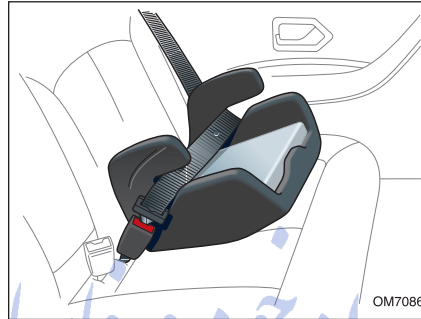

For heavy children – whose weight exceeds the limits of standard seat- who are equal or greater than 3 years old should be seated, a forward- facing booster cushion, in the rear of the car, using a 2 or 3 point (lap or inertia reel) seat belt.
(Especially suitable for children roughly 3 to 6 years old).

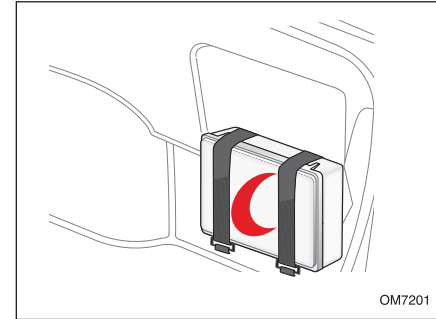

First Aid Kit

The box is mounted under the right side of the trunk by two sticky vertical straps. The box includes simple items suitable in case of accidents.

A first aid handbook is also placed in this box. It is advisable to read it carefully. Always replace consumed items, and keep the box in its location.

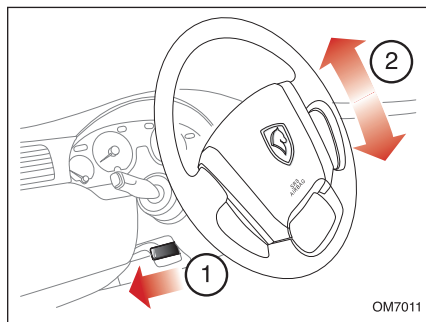

Adjusting Steering Wheel

Adjust the angle of the steering wheel to your body position before driving. Therefore, you should at first adjust your seat, and ensure that all the indicator lights and dials on the fascia panel are clearly visible. Then adjust the steering wheel on best position.

1. Push down the control lever to unlock the steering wheel.
2. Adjust the height of the wheel, and pull up the control level completely to lock in the desired position.

Caution:

Never adjust your steering wheel while driving. This is extremely dangerous.

FarmaSOS.com

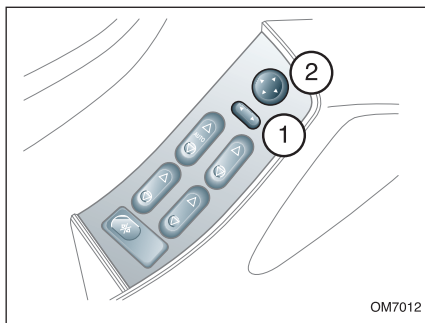

Adjusting Electrical Mirrors

1. Press the button no. 1 to select left or right side mirror after turning the switch on.

2. Press the button no. 2 in four directions to adjust the mirror to left, right, up and down directions.

Note: the projection in the mirror is viewed farther than real object distances.

Manual Adjusting of Mirror

Mirrors are designed so that they could be folded towards side windows while sealing narrow passages.

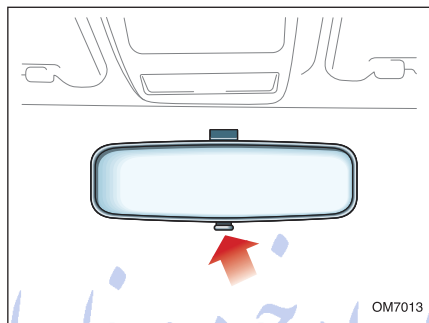

Rear-View Mirror

Adjust the mirror after seats and steering wheel are adjusted. Press the button beneath the mirror, and turn to "night" position to get rid of back cars glare effects. The mirror car returns to initial position by pulling the button forwards.

Note: The amount of light reflected into your eyes in the night position, is very small (comparing to its normal position), but sometimes it misleads the driver in recognizing the real position.

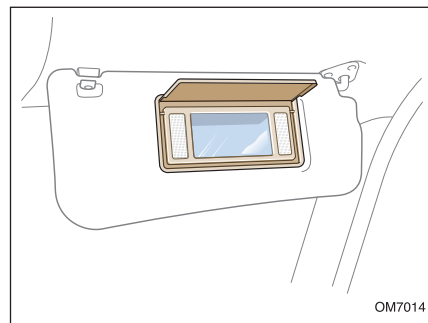

Sun Visor Vanity Mirror

Unfold the sun visor to use vanity mirror. There is a mirror cover in luxury models. There is a light, which turns on when the door is open, and turns off when it is closed.

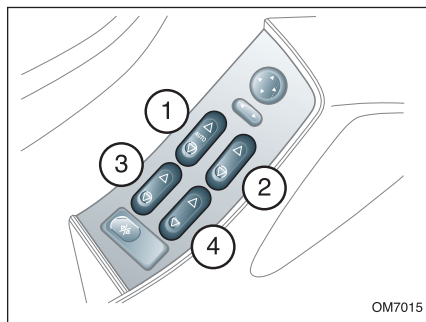

Side Windows

Driver's side adjusting switches are:

1. Left hand front window
2. Right hand front window
3. Left hand rear window
4. Right hand rear window

Driver's side adjusting switches can operate all four windows. By pressing switches, the driver can open or close the windows completely or lock the rear windows.

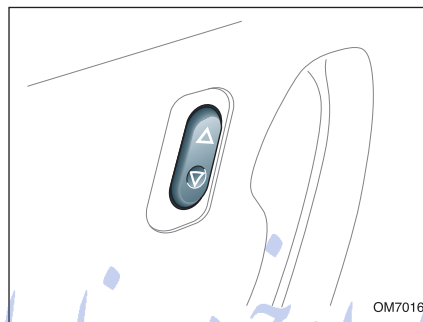

Switches

Any passenger can open or close their side window. Rear windows are not operable if the driver locks the buttons.

تلفن شبانه روزی: ۰۲۱-۸۸۸۶۲۰۸۵

FarmaSOS.com

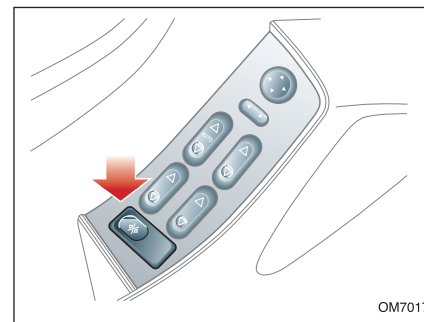

Rear Window Locking Switch

The rear windows cannot be operated by rear switches when locking switch have been turned on. This is a safety function when carrying children in the rear seats.

Caution: A power window won't stop if your fingers, hand(s) or head get in the way. You or others could be seriously injured

1 Heating and Ventilation

The heating and ventilation system provides fresh or heated air to the interior of the car from the intake grille in front of the windshield.

Air outlets are provided for the windshield, front passengers face and feet – and also there are air outlets for rear seat passengers on the middle console. Information concerning the operation of the heating and ventilation system, as well as the air conditioning appears on the pages that follow.

Care Point: Always keep the air intake grille clear of obstructions such as leaves, snow or ice.

Care Point: Do not obstruct rear passenger's air vents in the middle console.

Care Point: Keep the air grille in the rear window shelf uncovered to enable air flow through the whole of the interior.



OM7088

Caution:

Heating and Air Conditioning System

- To prevent the probable damage, use the distilled water in radiator.
- To help maintain optimum performance and durability of your air conditioner during the winter, it needs to be operated at least once for about 10 minutes every 15 days.
- It is recommended the system should be turned off before the engine.

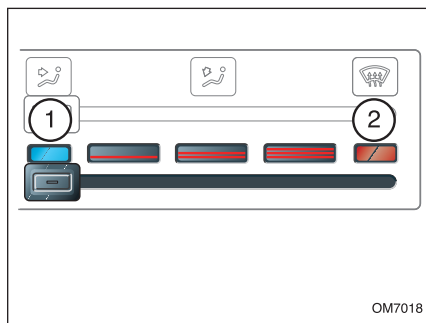

Temperature Adjustment

1. BLUE: Cold Air
2. RED: Hot Air

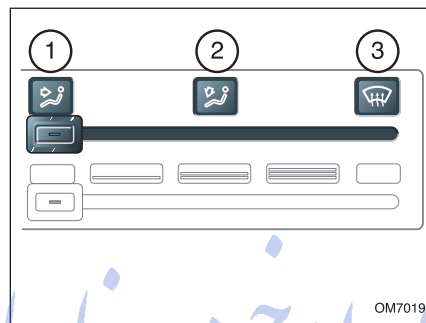

Air Distribution Adjustment

1. Center and Side Vents
2. Foot wells
3. Windshield and Side Windows

تلفن شبانه روزی: ۰۲۱-۸۸۸۶۲۰۸۵

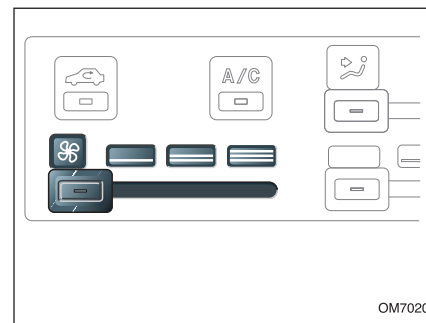

Air Flow Adjustment Lever

Slide the switch to the right position to increase the air flow.

FarmaSOS.com

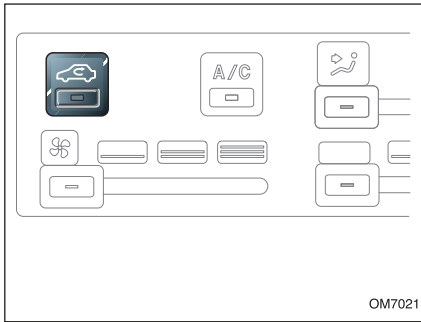

Interior Air Recirculation

Press corresponding button until the light turns on. In this position air exchange with exterior is disconnected and only internal air will circulate. Internal air circulation should be selected only in the following circumstances:

- Preventing exterior unpleasant odors
 - Rapid internal temperature fall/ rise
- This condition may result in misting windows. Put the system in normal position as soon as possible.

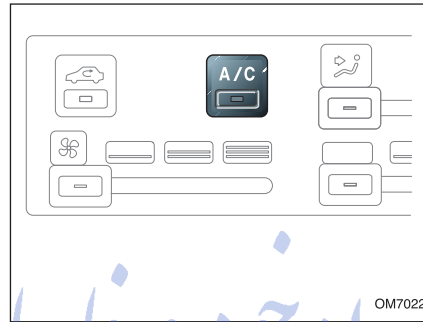

Air Conditioning

Press the switch to start operating when the engine is running. The light on the button turns on, and shows that the air conditioner is operating.

Note: Used simultaneously with the interior air recirculation, improves air conditioning performance, internal air circulation system is automatically activated. A slight screen misting maybe experienced when air condition system starts in highly humid conditions. The mist disappears a few seconds after starting.

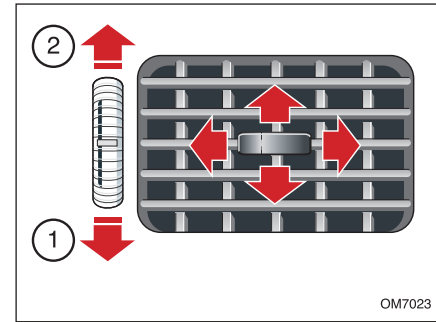

Center and Side Vents

Rotate the thumbwheel down to close the grill, and rotate up to open the grille. Move the grille button to sides, up or down to adjust air flow.

When carrying rear passengers, adjust driver side air grilles towards front seats, and central air grill towards back seats.

The following procedures will enable you to gain maximum benefit from the heating and ventilation system.

Demisting/Defrosting

a) In cold weather and for a better defrosting of windows:

- Select “windshield” on the air control panel
- Slide the air temperature control to the RED segment.
- Slide the blower switch to maximum.

By doing this you increase the windshield temperature and prevent the appearance of fog.

b) When the weather is pleasant but with high humidity:

- Slide the air temperature control to the blue segment.
- Select the interior air recirculation.
- Press air condition button.
- Select the minimum level of air blower.

By doing this you increase the windshield temperature and prevent the appearance of fog.

Using one of the above methods or a mixture of the two depends on your comfort when driving. In some cases opening one of the side windows up to 2 Cm will be useful.

Maximizing Heating System

- Set all air vents towards foot wells.
- Slide temperature control lever to the red section.
- Slide blower speed control level to the right as needed.

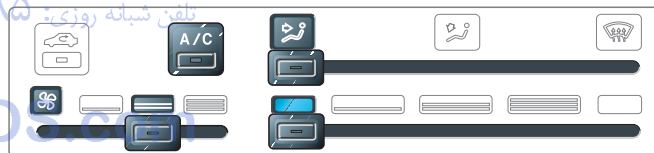
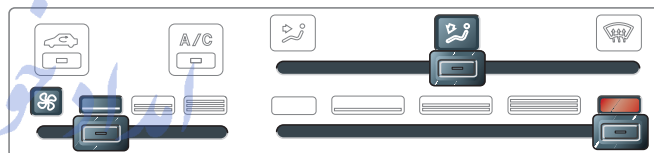
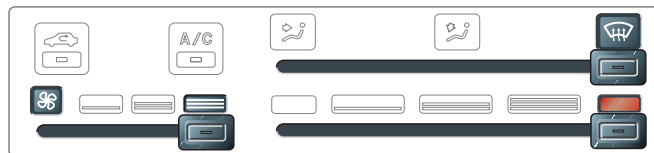

Maximizing Cooling and Air Flow System

- Set the airflow-adjusting key on “face ward” position and be sure that the grilles are open.
- Slide temperature control lever to the blue section.
- Slide blower speed control lever to the right as needed.
- Turn on air conditioning.

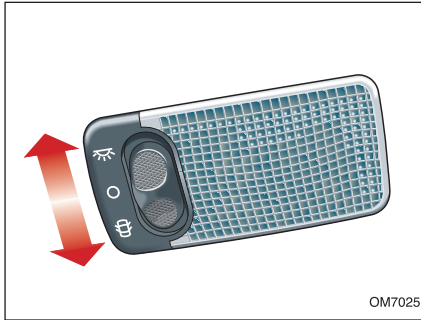

Front Courtesy Light

This light provides permanent lighting or the light comes on when one of the front or rear doors opens.

If the light is on with a door is opened, if the switch is closed, the light will turn off 15 seconds after the doors are closed

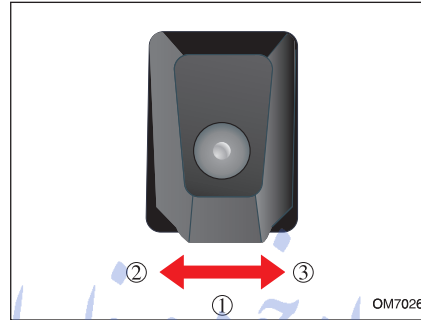

Map Reading Light

1. Off
2. Driver's side light is on
3. Passenger's side light is on

تلفن شبانه روزی: ۰۲۱-۸۸۸۶۲۰۸۵

FarmaSOS.com

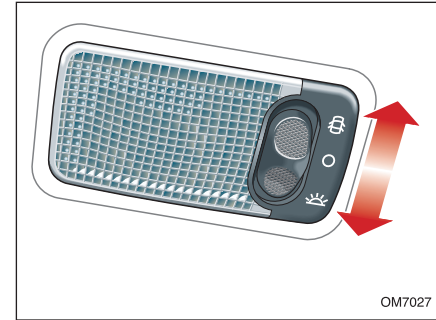

Rear Courtesy Light

This light provides permanent lighting or the light will come on by opening one of the front or rear doors.

If the light is turned on when a door is opened, if the switch is closed, the light will turn off 15 seconds after the doors are closed.



Light on

Light off

One door is open:
light on



One door's open:
light on

Light off

Light on

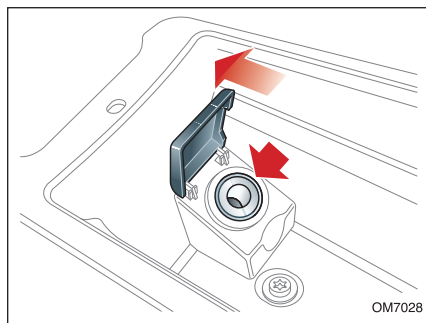

Power Source Connection

Power source location is in the cubby box and is used for charging mobile phone, or connection to other electrical devices.

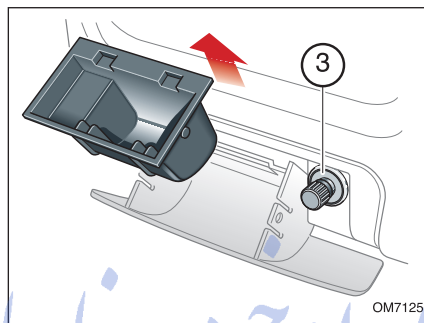

Front Ashtray

It is located on the lower side of the front console.

1. Press the cover to open.
2. Open the door and pull out the internal compartment to empty
3. Front cigarette lighter is located next to the ashtray

FarmaSOS.com

Caution: Ashtrays are a fire hazard. DO NOT use for waste paper or other combustibles.

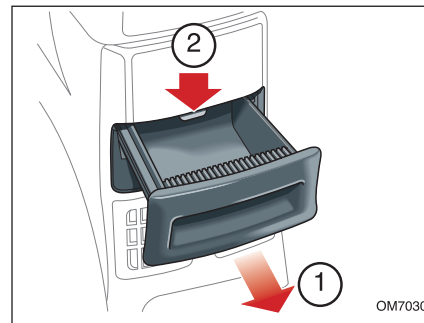

Rear Ashtray

It is located behind the central console. Pull the opening outward to open. At first push down the internal compartment downward, and pull out to empty as the figure shows.

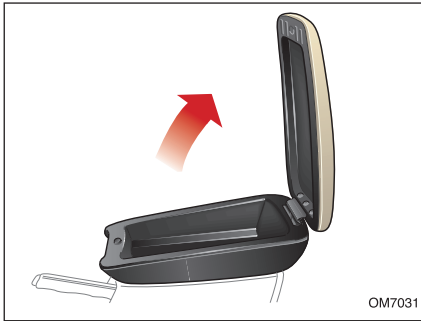

Cubby Box

The cubby box is located beneath the central armrest. Lift the lid to open it. An electric connection is fitted in cubby box.

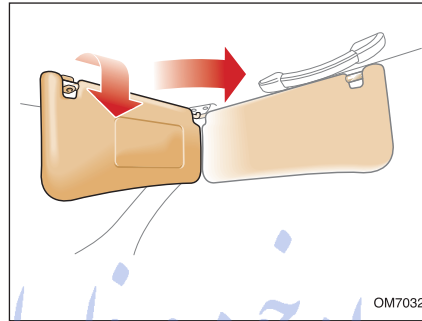

Sun Visor

Fold down the visor by the hinge to shield your eyes from direct sunlight. The visor can be used for both the windshield and side windows.

FarmaSOS.com

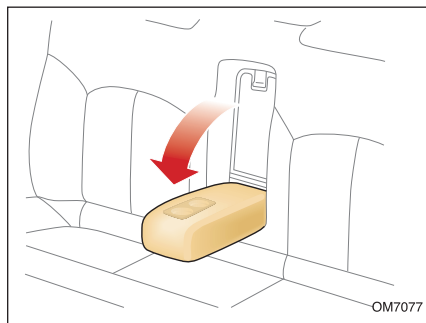

Rear Armrest

Fold down the armrest from the backseat cushion. The armrest provides more relaxation and comfort when carrying one or two rear passengers. Also in case you want to access the trunk hatch, fold down the armrest.

Two cup holding recesses have been arranged under the armrest.



Trunk Lid Release Handle

This hatch is located under the rear armrest, and is used to carry long objects- such as skis so that a part is situated in the trunk and the prolongation goes through the hatch to the backseats- or to access the trunk lid through passenger compartment.

- Lower the center armrest and release the catch at the top of the hatch and lower to lay completely on top of the armrest.

Caution: Long objects should be carried carefully.

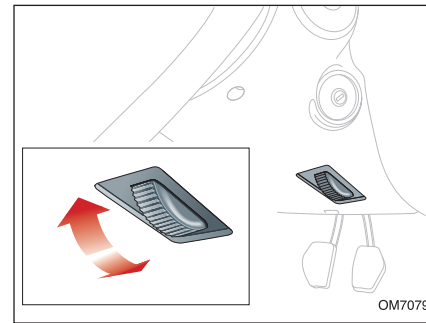

Adjusting Instrument Panel Dimmer

The switch is located below the steering wheel on the underside of the steering column cover.

Turn the dimmer backward and/or forward to decrease or increase the lighting of the instrument panel- the heating and ventilation adjusting keys light and cigarette lighter keys light.

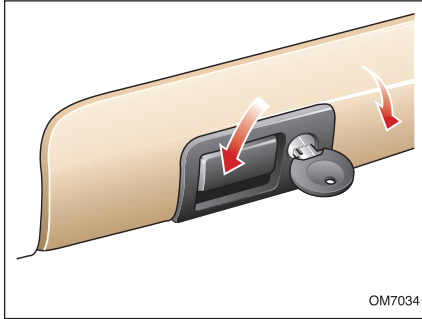

OM7034

Glovebox

- It is lockable.
- Turn the key to right to unlock.
- Turn the key to left to lock.

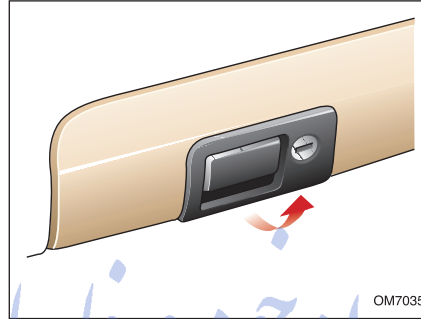

OM7035

Glovebox Opening

Pull the handle to open the glove box. The glovebox is illuminated on opening and lamp is extinguished on closing.

Note: The owner's manual should always be kept in the glove box for instant usage.

FarmaSOS.com

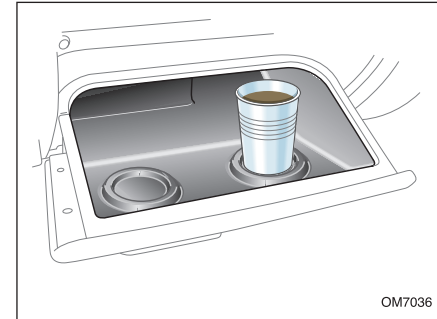

OM7036

Cup Holder

Two cups holding recesses appear on the glove box lid when it is fully open. Pay attention not to close the lid in this situation.

Pay close attention when the car is running and hot drinks are placed inside the holder.

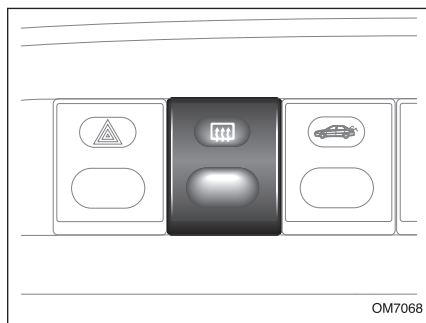

OM7068

Rear Window Heater

Press the corresponding key to turn it on. The lamp inside the key is lit when heater operates.

Note: the rear heater operates only when the switch is on.

Important: Avoid scraping and scratching the heating elements to prevent any damage, and do not stick any labels over them.

Side mirror heaters: turn on the rear window heater to remove any mist or frost.

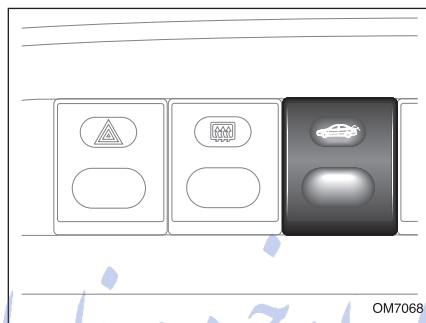

OM7068

Trunk Lid Key

To open the trunk lid from inside the car, switch on, and press the corresponding key at least 4 seconds.

The key does not operate when the central door locking system is activated by remote control.

FarmaSOS.com

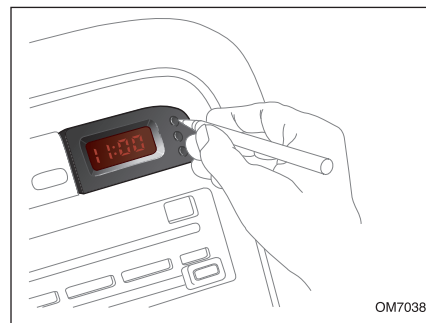

OM7038

Digital Clock

The clock operates on a 12-hour display basis.

Press the following buttons:



Hour set
Minute set
Reset Minute

Audio System

1- For more details about the audio system of your vehicle, please refer to owner manual of audio system that you received with the audio system.

امداد خودرو فارما

تلفن شبانه روزی: ۰۲۱-۸۸۸۶۲۰۸۵

FarmaSOS.com



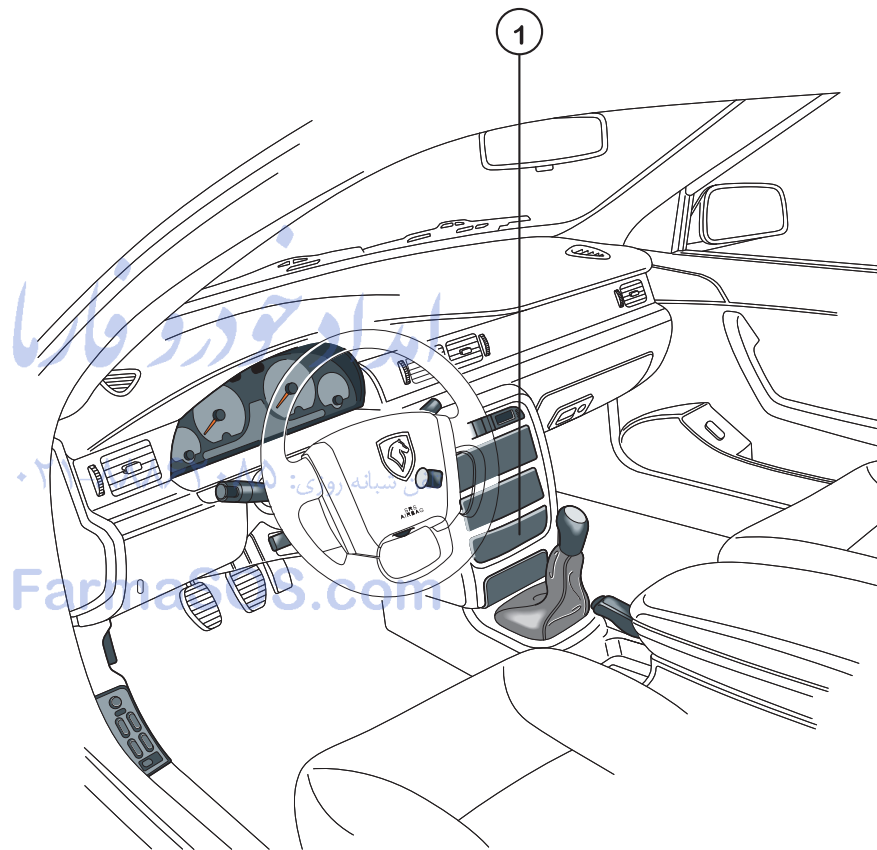



Audio – Video Alarm System Specification

1. Audio and video capability
2. LCD display
3. Keypad
4. Loud speaker
5. Temperature Sensor

System Capability

1. Warning messages are displayed on the LCD screen.
2. Vocal warning system to notify different messages.
3. Theft deterrent system with the following specifications:
 - a) 4 digit password possibility
 - b) shock sensor with ability of sensibility adjustment by software
 - c) Dual position LED memory.
4. Control timer for RLT roof light
5. Measurement of vehicle interior temperature and their display on LCD
6. Equipped with inertia switch for opening the doors in case of accident
7. Possibility of changing the back light by software

Audio-Visual Alarm System Specifications

1. During the course of driving, warning messages are displayed on the LCD and an audio message is broadcasted through speakers according to the type of error.
2. This system has tree principal menus and eight sub-menus in the settings menu, each provided for a specific purpose.
3. Theft deterrent system with 4 digit code and siren.

Buttons' Function

OK Button functions in all menus and confirms selected menu and and input data.

C Button is used to stop the sound of audio warning and to exit all menus.

By repressing of the **C** button, the audio warning system is activated.

P ↑ R ↓ Buttons are used for up and down, left and right moving.

L • Button is used to turn the instrument panel on and off.

R I Button is used to cut off the warning alarm when speed exceeds 120 KM an

hour and to cut the beep sound of keypad. By pressing once again this button the warning alarm option is turned on.

By pressing the *** +** button on the main menu you can adjust the LCD light from 0 to 100%

The sign  appears when air condition works.

Warning Message System



Warning system controls detectable problems when the car starts running. Two seconds after a problem occurs, the driver is notified in two ways:

1. One can hear the audio warning through the loud speaker
2. Video warning displays on the screen.

When the car is running, if any of the following problems occurs corresponding warnings are displayed and diffused:

1. The hand brake or brake liquid should be controlled
2. Oil pressure is low
3. Replace the brake pad.
4. Water temperature is high
5. Doors are open
6. Turn off the lights
7. Change the engine oil
8. Change the oil filter
9. Change the air filter

Warnings are played on speeds over 6 KM per hour and continues on four minutes intervals until the problem is resolved.

If the main lights are turned on when turning the switch off, the warning message "turn off the lights" is played and the above sentence appears on the screen. The problem concerning "replace the brake pad", "oil filter changing", "air filter changing" are played every hour. Press  button to cut the warning sound.  appears on the screen. The warning message appears but no sound

is heard.

 Button does not cut the message related to the lights being left on and the message will continue in all situations.

Theft-Deterrent System

When the remote keyless system is used to lock the car, all doors, hood, the trunk lid and fuel filler cap are locked and theft-deterrent system is activated. The message "the anti-theft system is active" appears on the screen and the panel light or the corresponding signal (🚗) blinks on the instrument panel.

If you lock the doors with the key, theft-deterrent system will not be activated.

In addition to the usual theft deterrent system means, the intelligent theft deterrent system of Samand is equipped with extra capabilities as follows:

- a) 4 digit code
- b) Shock sensor with ability to be set up by software
- c) memory LED in two positions



(1)

Activation Time of Theft-Deterrent System

If the car is in "unlock" mode, the "lock" button is pressed, and doors are closed: The doors are locked and shock sensor is activated after 7 seconds. Siren and flasher are triggered once. If there is any impact against the vehicle at this time, the shock sensor is triggered depending on the predefined sensibility. Therefore siren and flashers are activated continuously for 30 seconds and the map reading light stays on for 30 seconds and the danger sign is displayed(2). If shock sensor remains active for about 30 seconds, siren and flasher are triggered for 30 seconds too, map reading light stays on and this trend continues, if the shock sensor is not triggered, the system returns to theft deterrent position and memory LED remains on, showing a danger till the vehicle starts.

If in theft deterrent position one of the doors becomes open, like the previous situation, siren and flasher are triggered, and the system checks the door after 30 seconds. If door is closed the system

returns to theft deterrent position, if not, door opening alarm in theft deterrent position is activated, meaning that the siren and flashers are continuously activated during 30 s. When the vehicle is in theft deterrent position, if (On) button on the remote control is pressed, siren and flasher turn on once for confirming the activated theft deterrent position (Panic) and map reading light turns on and turns off with delay.

Remark:

- 1- Activating siren once means : siren works for 20 ms.
- 2- One time activating of flasher means, flasher works for 500ms



(2)

4 digit code:

when the vehicle is in theft deterrent mode and unlock (Off) button is pressed:



a) If 4 digit code is activated on the intelligent system (menu 3), figure 3 appears, after unlocking and opening the door, if at the end of the specified time in the code duration setting page, no code is entered or is entered by mistake, intelligent system shifts to alarm system and siren and flashers work for 30 s (figure 5). It should be noted that the code can be entered three times in a row and if the code is entered by mistake for the third time (figure 4) system shifts to alarm position.

b) And if 4 digit code is not activated and door is not opened during 10 seconds, the vehicle shifts to lock and theft deterrent position, unless one of the buttons on the key pad is pressed or the vehicle is started.

Alarm System (Normal Position)

When the system is not in theft deterrent position, the following capabilities have been included to the intelligent system:

a) When the vehicle is off and driver leaves the vehicle and door is closed, after 5 seconds, the siren triggers 5 times on 200 ms intervals for reminding to lock

the vehicle.

b) Doors are opened with button 1 and closed with button 3 on the intelligent system keyboard.

c) When the speed of vehicle exceeds 20 Km/h, doors will be locked automatically and they will open when the vehicle is turning off.

d) Map reading light turns on when a door is opened and if the vehicle is off and door is closed the light turns off progressively with delay, and if the vehicle is on, the light turns off immediately but progressively.

Map Reading Light Timer (RLT)

Map reading light control comes on by activating intelligent system and operates in the following situations:

1- While the vehicle is off and the vehicle door or trunk is opened, this light turns on and while the door is closed, the light stays on for 18 ± 2 s and then turns off progressively.

2- While the vehicle is on and its door or trunk lid is open, the light is on and when the door is closed, the light turns off immediately but progressively.

3- When the vehicle is in theft deterrent position, by pressing the On (lock) button, light stays on for 18 ± 2 s then turns off progressively.

4- When the vehicle is in theft deterrent position, by pressing the off (unlock) button, the map reading light turns on and if before auto lock time expiration, door is opened it will operate as stated in paragraph 1, if not auto lock will be activated and the map reading light will turn off.

5- After turning off the vehicle and leaving it, light remains ON for 18 ± 2 s

and if the lock button is pressed before this time, map reading light turns off simultaneously with the doors getting locked, progressively and without delay.

6- In the case of danger and alarm, the map reading light remains on till the end of the theft-deterrent alarm position.

How the Background Light Turns on and Off?

Effective factors influencing on background light turning on and off are as follow:

1- Alarm Position

2- Anti-Theft Position

3- L key

4- Front Light On/Off Position

5- On/Off Position

6- Keyboard keys (except L)

7- Messages display

1- Alarm Position: As long as the danger sign is on the display panel, the "background light" is switched on in all positions and at the end of such situation it will turn off.

2- Theft-Deterrent Position:

In this position, if there is a separate LED for theft deterrent on the front ampere

the "background light" will be off on all situations; otherwise "background light" will turn on every 5 seconds for 200ms.

3- L key:

When the engine is running:

If the "background light" is off, by pressing the L key, "background light" will turn on and remain on in every situation.

If the "background light" is on, by pressing the L key, it will turn off and the way it turns on once again will depend on occurring situations.

When the engine is off:

If the "background light" is off, it will turn on by pressing the L key.

A- If lights are on, the "background light" will remain on.

B- If lights are off, "background light" will turn off after 30 seconds.

If "background light" is on, by pressing the L key:

A- If lights are on; "background light" will not turn off.

B- If lights are off, "background light" will rapidly turn off.

4- Front Lights:

A- If lights are on, "background light" will remain on permanently, except in the case of one of the above mentioned situations and necessity of "background light" turning off

B- If lights are turned off:

1- If "background light" is turned on by pressing the L key it will stay on.

2- If "background light" has not been turned on by pressing the L key, it will turn off quickly.

5- The Second Position Of the Switch

Considering all the above priorities:
A- If the engine is turned on, "background light" will stay on for 30 seconds and then:

1- If "background light" has been turned on by pressing the L key, it will stay on.

2- If it hasn't been turned on by the L key, it will turn off.

B- If the engine is turned off, the activation or deactivation of the "background light" will occur according to the above priorities and "engine off" position.

6- Keys on the "keyboard" (except L)

By pressing any key, it will turn on for 30 seconds and turn off according to the above priorities.

7- Message Display:

During message display, "background light" is on and after that, it will stay on or turn off according to the above priorities.

*** On all the above situations, the intensity of the "background light" is according to the last adjustment done by the driver.

Automatic Lock:

If the theft deterrent system is activated, if the "open" key is pressed on the remote control, but none of the side doors, hood door or trunk lid are opened within 10 seconds, the theft deterrent system will lock all side doors, hood door and trunk lid automatically. This is called the "automatic lock" position. After turning

the engine on and speeding up to 20 km/hour, doors will be locked and unlocked after turning off the switch.

Car Finder:

When the theft deterrent system is activated, by pressing the "open" button on the remote control, flashers will blink to help find the vehicle among others.

Resetting the Theft-Deterrent System

Caution:

None of battery cables should be disconnected more than 15 minutes, otherwise temporary ECU memory will be erased.

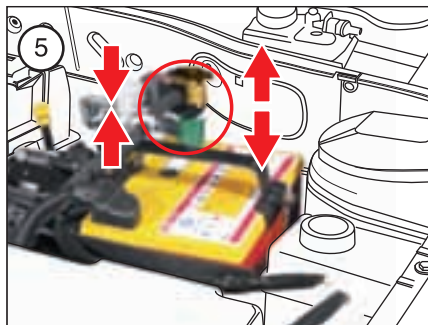

For resetting the system the battery and siren connector should be disconnected and reconnected.

You can disconnect the siren by the special switch that has been delivered to you

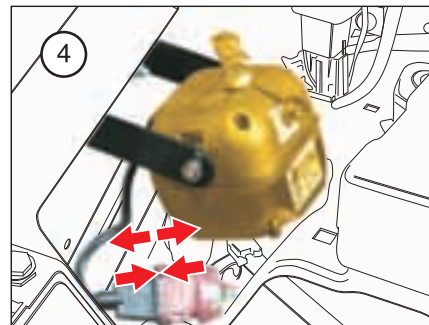
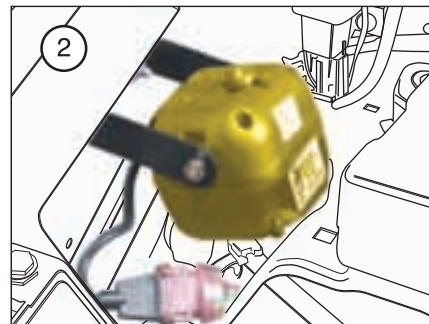
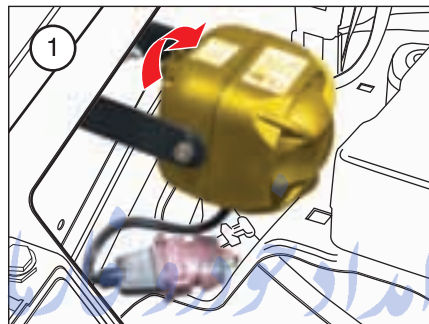

Disconnect the siren connectors and unscrew battery terminal negative cable and remove the battery cap. Then once again, first place the battery cap and tighten its screw, then set the siren connector and set the switch to on position. Now, the system is reset and time adjustment should be renewed.

Alarm System General Information

If the car speed exceeds 120 KM per hour, warning alarm is heard and beeps increases in number when the car speeds up. The alarm can be turned on / off by pressing **R ↓** button. The keypad lamp and the display screen light up when main headlights are turned on.

The default display illumination intensity is 50%. Display on or display off options and the illumination intensity are memorized as default.

The clock is displayed in the main menu screen as default setting. Refer to menu 4 explanations for clock adjustments. On the main menu press button **1 00** on the keypad to unlock doors and **3 def** button to lock the doors.

This option can be used to open the doors in speeds over 20 KM /h.

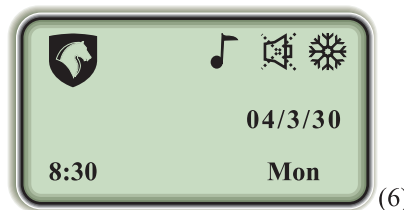

Main Menu

System menu details are as follows:

- 1- Distance Display
- 2- Oil Filter
- 3- Settings
 - 3-1 Temperature Adjustment
 - 3-2 Shock Sensor
 - 3-3 Code Settings
 - 3-4 Clock Adjustment
 - 3-5 Date Adjustment
 - 3-6 Contrast
 - 3-7 Language Changing
 - 3-8 Default Settings



(7)

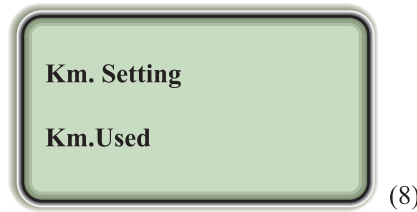

(8)

The main menu display is according to (7), we can choose one of the 3 options by pressing the **R ↓** or **P ↑** keys and entering the corresponding menu by pressing **OK**. On this page by pressing the **C** key the main menu appears. To enter adjustment menu, the **OK** key should be pressed for one second.

Distance Display Screen

On this screen the distance is shown in kilometers (8). Any time the **OK** button is pressed, the distance will be reset to 0 and it will restart from 0.

Oil Filter Screen

This page is divided into the kilometers adjustment page and usage.

FarmaSOS.com

Kilometers Adjustment:

When adjusting oil level, oil filter or air filter it is possible to enter the maximum amount of proper usage for oil or air filter in kilometers (9).

Oil	6000
Oil Filter	7500
Air Filter	12500

(9)

To change the kilometers setting, **R ↓** **P ↑** should be pressed and then press **OK** to confirm. By pressing **OK**, the message "should the adjustments be confirmed?" is displayed (10). If the **OK** key is pressed, the changes will be confirmed; otherwise, by pressing **C** key, the changes will not be considered.

Are you sure?

(10)

Usage:

In this menu the usage of oil, filter, air filter is shown in kilometers. By pressing the **C** key, this page is closed.

Driver Information Display Menus:

There are 8 sub-menus in the warning system. By pressing the **OK** key on adjustments, the sub-menu is activated (11).

1

By pressing the **R ↓** or **P ↑** keys choose the desired menu, and then press the **OK** key (12). After termination press the **C** key to exit menu.



(11)

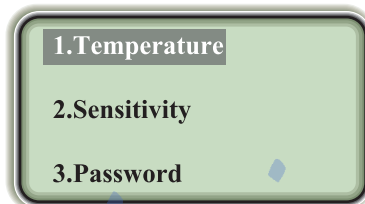

(12)

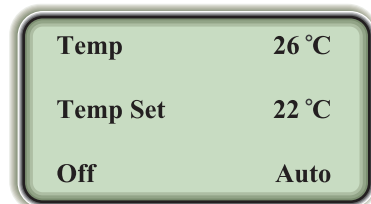

(13)

Option Menu1:Temperature Setting

Interior temperature is the temperature inside the car.

"Adjusting Temperature" is the temperature chosen by the driver.

This menu will give you the ability to adjust the temperature inside the car only when the air conditioner is on.

By pressing the **R ↓** key, temperature decreases.

By **P ↑** pressing, temperature increases.

By pressing the **OK** key, you can choose the automatic or manual positions.

In Default position AC will remain on and there will be no control over the temperature. In "Automatic" mode, to "decrease" to the internal temperature set by the user, the AC system will turn on till it maintains the selected internal cabin temperature. **This system (AC) can not adjust the temperature while the heating system is working.** The activation or deactivation of the AC is shown by **on** or **off** (13):

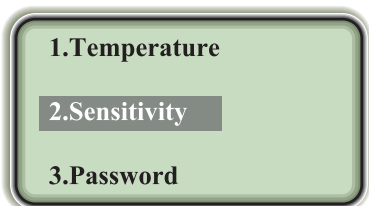

(14)

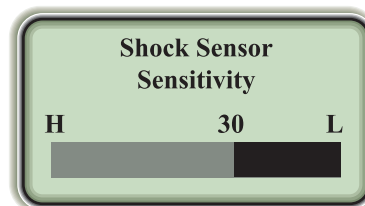

(15)

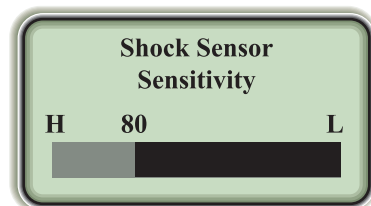

(16)

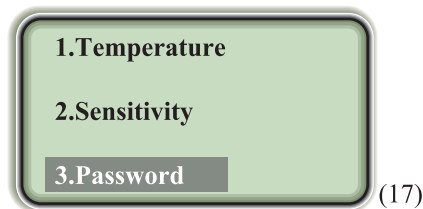

(17)

Option Menu2: Theft-Deterrent System (Shock Sensor)

Press this button **OK** to navigate to option menu 2. In this menu you can choose the sensitivity of the shock sensor (14).

Shock Sensor Display

By pressing buttons, the shock sensor sensitivity can be altered from 0 to 100 (15). When the sensitivity is 100, the theft-deterrent system will be activated even by the smallest shock. On the opposite, when the sensitivity is near to 0, the alarm system will be activated only after a heavy shock and if the "shock sensors" are placed on 0, the alarm system (sire) will be totally inactivated. Press **C** button to exit the menu.

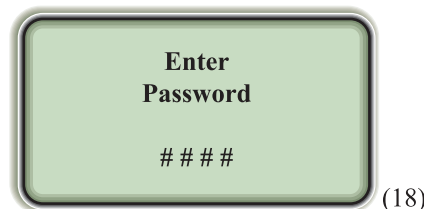

(18)

Option Menu3: Security Code Setting

Press **OK** button to navigate to Option Menu 3. This menu allows the user to (13):

- Change the 4 digit code number.
 - Reset the time allowed for keying in the 4 digit code number.
 - Activate or deactivate the 4 digit code number.
- To make any changes in this menu, you must enter the correct 4 digit code number (18).

If the correct code is not entered, this message will be displayed: "Security Code is incorrect" and the menu will be closed down. After the correct code has been entered, a sub-menu will appear (19).



By pressing the **R ↓** and **P ↑** buttons you can move between different positions.

If the code is activated (20), you have to enter the four digit code number before starting.

Four Digit Code Number Changing:

Pressing this button **OK** selects the option to "Change Security Code(21)". You will then be able to enter a new 4 digit code number(22).



If the code is not activated you do not need to enter the four digit code number before starting.

The default code is 1111 and you can change it as you wish. In default mode the four digit code is deactivated. If you forget your four digit code and a problem occurs for the system, you can reset the system as mentioned; in this case the default codes will be 1111.

After entering the four digits, you will be requested to enter the new code number once more(23). If two digits of this entry are the same, this code number will change to become your new 4 digit code number. If digits do not match, the following message will be displayed: "The security number is incorrect" and no new security code will be set.



(23)



(24)

Selecting the Timing of the Four Digit Code Number:

By pressing the **R ↓** button select the "adjusting code duration" mode.

In this way you can change the duration for entering the code.

By pressing the **OK** key, 4 options will be displayed on the screen for duration (24).

you can adjust the desired time.

By pressing the **R ↓** button the selection sign will move to

the left and by pressing the **P ↑** button it will move to the right. By pressing the **C** button, display screen will be closed.

The duration for entering the code will start at the opening of doors or pressure on one of the system keys.

By pressing the **OK** button on the "four digit code number" mode you can activate or deactivate the "four digit code number" mode (25)

FarmaSOS.com

New Password

Password time

Active

(25)

In activation mode the start will not operate until the correct code number is entered and when exiting the theft deterrent mode, the system will ask for the four digit code number

By pressing the **C** button exit the menu. When the code number is activated, it is not possible to open the hood without entering the code and the alarm will go on.

If the code is deactivated, when exiting the anti-theft mode, there is no need to enter the code(26).

New Password

Password time

Inactive

(26)

4. Clock

5. Calender

6. Contrast

(27)

Option Menu 4-Clock Setting

By pressing the **OK** key, enter menu 4(27).

In this mode a dark line will appear under the time digit (28).



12:15:00

(28)

FarmaSOS.com

تلفن شبانه روزی: ۰۲۱-۸۸۶۲۰۸۵

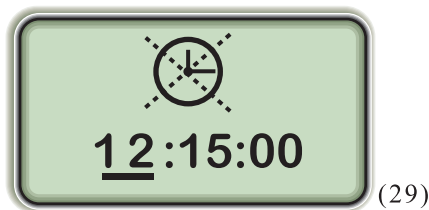

By pressing the **R ↓** and **P ↑** buttons adjust the clock digit.

By pressing another time the **OK** button you can move on the minute and second digits and adjust them accordingly.

By pressing the **مه 1** button you can activate or deactivate clock display on the main menu (29).

Clock display in this system is 24 hours mode.

Exit menu by pressing the **C** button.

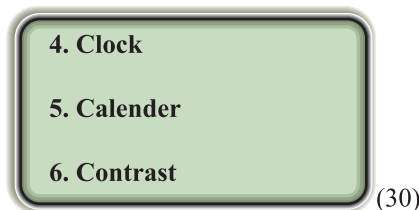

Option Menu 5- Date Adjustment

By pressing the **OK** button enter menu 5(30).

In this menu you can choose the day, year, month and weekdays options.

تلفن شبانه روزی: ۰۲۱-۸۸۸۶۲۰۸۵

FarmaSOS.com



By pressing the **OK** button the dash sign will move between year, month and day (31).

By pressing the **R ↓** and **P ↑** buttons, adjust the date.

If the date is adjusted, weekdays will be adjusted automatically.

The range of adjustable date is 50 years.

By pressing the **OK** button, exit menu.

6. Contrast

7. Language

8. Default

(32)

7. Language

8. Default

9. Temperature

(34)

Option Menu 6-Contrast

By pressing the **OK** button enter menu 6(32)In this menu you can adjust the contrast of the display screen.

By pressing the **P ↑** button contrast percentage goes up.

By pressing **R ↓** button the contrast level will decrease (33).

By pressing the **C** button, exit the menu.

Option Menu 7-Change of Language

Enter menu 7 by pressing the **OK** button(34).

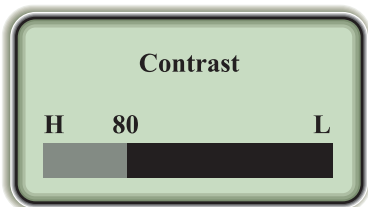

(33)

تلفن شبانه روزی: ۰۲۱-۸۸۸۶۲۰۸۵

FarmaSOS.com



In this menu you can change the language to Farsi, Arabic, English or Russian by using **R ↓** and **P ↑** buttons(35). By pressing the button all messages, commands and voice messages will be displayed in the chosen language. Exit menu by pressing the button.

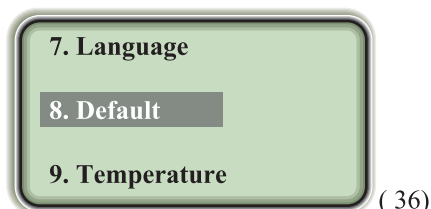

Option Menu 8- Default Settings

Enter menu 8 by pressing the **OK** button(36).

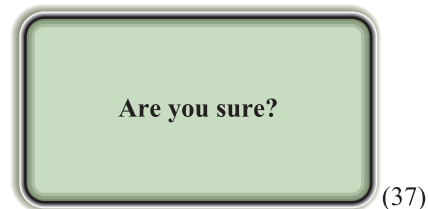

By selecting this option and pressing the **OK** button the message "confirm the changes" appears on the screen (37). If the **OK** button is pressed once again, the changes will be confirmed and if the **C** button is pressed, changes will not be taken into account. The sensitivity of the shock sensor and the display contrast will return to default settings. The inside temperature control will return to manual.

تلفن شبانه روزی: ۰۲۱-۸۸۸۶۲۰۸۵

FarmaSOS.com

2 - DRIVING



Instrument Panel Indicators
Instrument Panel Digital Indicators
Warning Lights
Switching On And Driving
Driving And Saving Environment
Manual Gears
Reverse Gear Warning System
Fuel System
Lights And Indicators
Horns
Brakes
Wipers & Washers
Anti-lock Braking System (ABS)
Air Bag System

INSTRUMENT PANEL

2

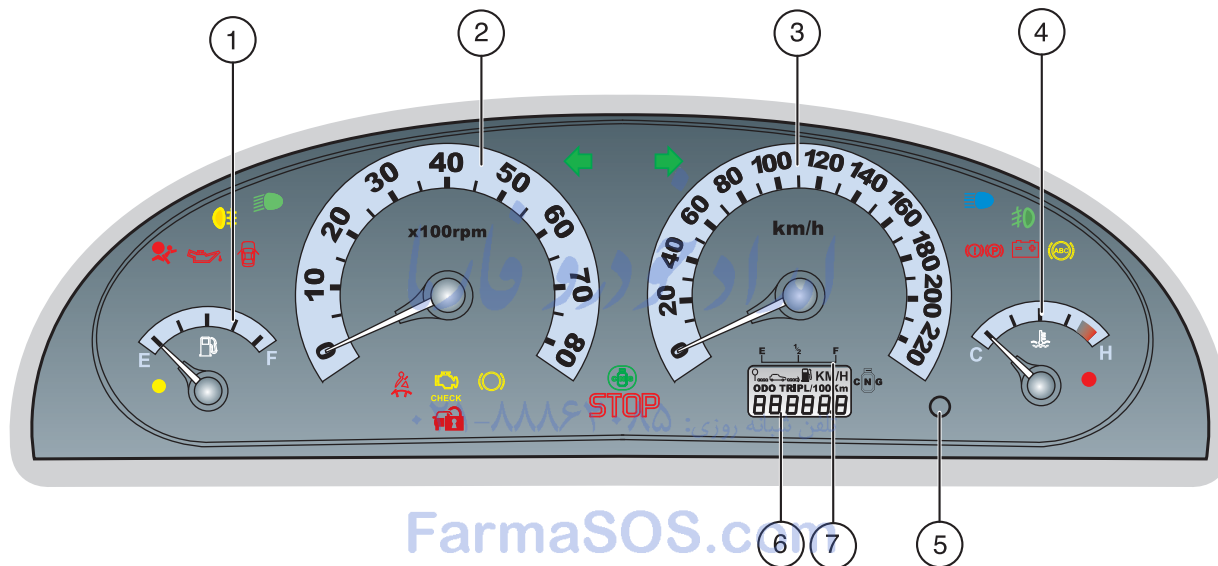

1. Fuel Gauge

2. Tachometer

3. Speedometer

4. Coolant Temperature Gauge

5. Distance Recorder Reset Button (Trip Recorder Reset Button)

6. Digital Display Panel (Trip Recorder)

7.CNG Digital Display*

*Bi-Fuel Vehicle



Fuel Gauge:

The pointer falls to zero when the ignition switch is off, but it shows the tank fuel level when the switch gets on. A warning indicator light in the fuel gauge lights up when the fuel level falls to 7 liters.

Refuel as soon as possible. Fuel tank capacity is 66 liters.

Tachometer:

It shows the engine speed in revolutions per minute(*100). To avoid engine damage, never let the tachometer pointer remain in red section for a long time.

Speedometer:

It shows the speed of vehicle in Km/h.

Coolant Temperature Gauge:

This gauge indicates the temperature of the engine coolant. When the engine warms up, the pointer rises to the middle of the gauge, and it remains until the engine operates in normal condition.

If the pointer reaches the red section, it shows that coolant is overheated causing damage to the engine. In this situation stop the vehicle immediately considering safety conditions and seek help from qualified persons to repair.

Possible Causes:

- A faulty fan- Check fuses, and change them if necessary.
- The coolant system leakage; let the engine cool down, and then check the coolant liquid level.
- A fault in the water pump operation

Distance Recorder Reset Button (Trip Recorder Reset Button):

It is used to show different situations in the digital display panel and reset information in the related condition.

Digital Display Panel (Trip Recorder):

For more information, refer to the related page of this booklet.

Direction Indicators-Green



The directions of indicators (turning to the right and turning to the left) are defined by arrows. When you turn on the left or right signals, the corresponding green arrow on the instrument panel will flash along with the respective turn signal lights. If the flasher (hazard warning light) is used, both indicators flash together. If either warning light flashes very rapidly, this means that the corresponding direction indicator is not operating. In addition to direction indicator lamps, there are some lamps on the side mirrors which flash simultaneously with other indicator lamps.

NOTE: This situation occurs only when one of the front or rear direction lights does not work properly, but if one of the side lights is not working, it will have no effect on the warning light flash frequency.



Important Remark: If the vehicle experiences an excessive speed fall, the alarm system automatically turns on the flasher for 10 seconds.

This is a warning sign for excessive speed fall.

Headlights Dipped Beam - Green



It lights up when using dipped (dimmed) headlights

Headlights Main Beam – Blue



It lights up when using main-beam headlights

Front Fog Lights – Green



It lights up when using front fog lights – green

Rear Fog Light – Yellow



It lights up when using rear fog lights.

تلفن شبانه روزی: ۰۲۱-۸۸۸۶۲۰۸۵

FarmaSOS.com

Immediate Stop Command – Red

STOP

Stop the car, and turn off the engine when it lights up. Contact immediately an authorized dealer or workshop.

Automatic Engine Troubleshooting Device – Yellow



This indicator lights up when the engine troubleshooting device detects a failure.

When the switch is in the second position (on), as a sign of system check up, this light turns on and after the engine is turned on it will turn off. It will resume lighting if any engine problem occurs while driving.

NOTE: If the indicator lights up and the car operate normally, refer to an authorized dealer, although, you can still drive. If the indicator lights up, the car does not operate normally. Do not drive on high speed and refer to an authorized workshop immediately.

Oil Pressure-Red



It lights up when the ignition switch is in the second position to indicate correct operation and it will turn off when the engine starts. If the oil light stays on when starting the engine or turns on when driving the car, the engine is exposed to a serious damage, the vehicle should be stopped immediately and the engine turned off while taking into account safety considerations . Get help from an authorized expert before moving the vehicle once again

Battery Charging – Red



It lights up as a bulb functioning check when the ignition switch is in second position and it will turn off immediately when the engine starts. If it remains on when starting or lights up when driving, there is a problem in the battery charging system. Immediately refer to the workshop to conduct repair.

Doors Open-Red



It lights up when at least one of doors is not closed properly. It operates even when the engine is off. Avoid driving when indicator lights up.

Brake System Alarm – Red



This indicator is turned on for a few seconds while starting the engine and then it turns off, and it turns on when the hand brake slides up or when the brake fluid level is low. If the indicator of brake system alarm doesn't work or remains on while starting the vehicle or after sliding down of hand brake, without delay fill the brake liquid reservoir and if the indicator remains on after filling the reservoir and sliding down of the hand brake, while considering safety precautions, transfer the vehicle to an authorized workshop for evaluation and repair.

Driver Safety Belt – Red



By locking of the metal tongue of the driver safety belt in the special buckle and with a “click”, we make sure of its locking. With this action the indicator on the panel is turned off.

Anti – Lock Brake Warning System (ABS) – Yellow



It lights up when starting the car and keeps on for a few seconds, and then it turns off. If it does not turn on when starting the engine or stays on after the engine starts running, it indicates that there is a problem in the anti-lock brake system. In such a condition move the car immediately and with safety considerations to the authorized workshop for inspection and repair.

Brake Pads – Yellow



It lights up to alert that the brake pads should be checked and replaced if necessary.

Low Fuel Level Warning- Yellow



Next to the fuel gauge there is a warning light, when the light is on it shows that less than 7 liters of fuel remains in the fuel tank. Refuel as soon as possible.

High Coolant Temperature Warning – Red



Beside the coolant temperature indicator, there is a warning light, if the coolant temperature pointer stands in the red section and the lamp lights up, stop immediately (without the engine turning off) and seek help from an authorized expert.

Theft Deterrent System Warning - Red



It indicates that the theft deterrent system is activated when blinking.

Air Bag Alarm System - yellow



turning on or off of this indicator means that there is problem in this system.(with opening of switch, this indicator remains on for 6seconds and become off if there is no problem).

CNG Pointer Symbol-Green*



If fuel consumption changes from gasoline to CNG, this indicator turns on.

*Bi-Fuel Model only

Instrument Panel Display Instruction

This indicator is located at the bottom of the Instrument Panel (lower than the speedometer). By pushing the supplementary keys for adjustment (reset button), you can change MODE and access the following information: If you press the lever for one second, MODE position is turned on. By holding the lever down for about two seconds, the information is reset.



(MODE1): This mode is lit when the ignition switch is turned on. In this mode the total distance (Km) from delivery time is shown and has no possibility to be reset.



(MODE 2): This mode shows the distance (Km) after resetting the latest time.



(MODE 3): The Third mode shows the average of the total used fuel (L) after resetting the distance.



(MODE 4): It shows the average

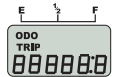

This indicator shows the current amount of remaining fuel in the rear tank**

FarmaSOS.com

*If equipped

**Bi-Fuel Model only

Starting the Engine

1-Check that the hand brake is pulled, and the gearbox is in neutral position.

2-Switch off all unnecessary electrical equipment (including the air conditioner)

3-Turn the ignition key to the third position, and release the key immediately when the engine starts.

Do not press the accelerator pedal while starting, and do not keep on starting more than 15 seconds each time. If the engine does not start, wait 10 minutes, and then restart.

When the engine does not start, or does not continue running,

- Press the accelerator half way down while switching on. Do not keep on switching over 15 seconds, and release the switch as soon as the engine starts.

- If the engine fails to start, press the accelerator fully and repeat the starting sequence so that the engine is freed from residual gasoline, the switching should not take longer than 15 seconds, release the accelerator as soon as the engine starts.

- Do not press or release the accelerator while starting.

NOTE: Never race the engine before it warms up (Do not speed the vehicle). If the engine does not turn off with the key, press the brake pedal, engage the gear, and release the clutch to turn off the engine.

Cold weather

In temperatures less than -10°C, the car needs more time to start. Since the start has to work longer, turn off all unnecessary electric devices when starting.

Warming Up the Engine:

For economizing in fuel consumption, move the car immediately after starting, but remember that pressing heavily on the gas pedal and forcing the engine before warming time is up can hurt the engine.

Parking the Car :

Always pull the hand brake and neutralize the gear after parking and before releasing the brake pedal and turning off the engine

Breaking-in:

The engine, gear box, brakes, and tires need time to get adapted for normal driving. During the first 1000kms, it is necessary to drive with precaution and to follow the directions as stated below:

- Do not let the engine speed to exceed 3000 revolutions per minute on any gear level.

- Do not push the gas pedal until the end at any speed

- Do not force the engine at any gear level

- If possible do not force the brakes excessively

After breaking-in distance is covered you will be able to use higher engine speeds gradually.

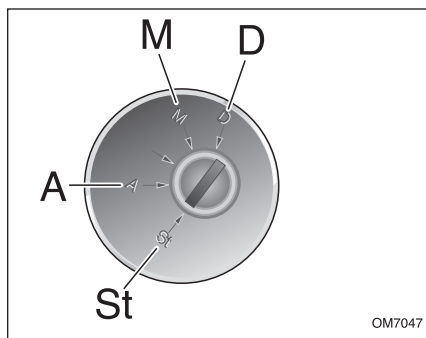

Unlocking the Steering Wheel

Turn the switch after inserting with a gently movement of the steering wheel. Put it in the first position to unlock the steering wheel.

Locking the Steering Wheel

After you removed the switch, turn the wheel toward the curb, and turn it to lock the wheel switch starter.

Start Switch

POSITION St

- The switch can be removed
- The steering wheel is locked
- Most lighting is opera tableside lights, headlights and flasher.

POSITION A

- The steering wheel is unlocked.
- Some electrical accessories and equipment operate.

POSITION M

All equipment, warning lights and electrical circuits operate.

POSITION D

- The engine is switched, and releases the switch immediately after the engine runs. The switch automatically returns to the second position.

تلفن شبانه روزی: ۰۲۱-۸۸۸۶۲۰۸۵

Caution:

When the car is moving do not turn off the engine or remove the key, since the steering wheel gets locked and the control of the car will be impossible.

Caution:

Avoid starting and running the engine in confined spaces for too long.

PRESERVING THE ENVIRONMENT

2

You can reduce environmental pollution and drive more safely and economically by observing following advices:

- Use the factory recommended gasoline and engine oil.
- Prevent gasoline overflow while filling the tank.
- Do not forget to conduct periodic checks on your vehicle
- Check that the exhaust, oil and fuel system do not have any leakage.
- Begin driving slowly and right after turning on the engine.
- Turn off the engine for stops longer than 2 minutes (i.e in traffic jam or behind red light)
- Press the gas pedal slowly and do not speed up suddenly. Try to keep a steady speed to reduce not only exhaust pollutants, but to prevent mechanical parts erosion.
- Pay attention to the maximum allowed speed.
- Adjust tires pressure and balance them if necessary.
- Minimize using the air conditioner to reduce fuel consumption.
- If you changed the engine oil by yourself, do not drain the used oil and deliver it to the refill oil stations for recycling.
- Plan your trips, and combine them together.
- Avoid driving in busy streets or rush hours as much as possible.

FarmaSOS.com

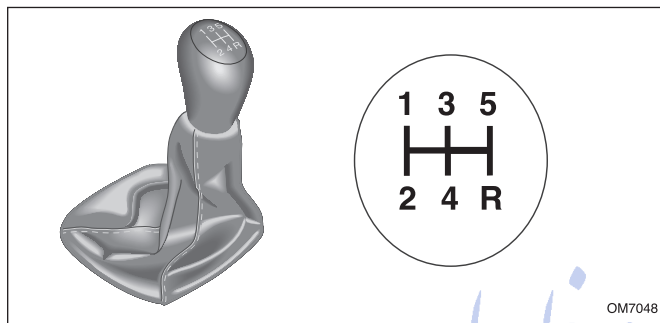

GEAR POSITIONS

The gear positions are indicated on the gear lever knob. The gearbox is equipped with synchronization in all gears (even reverse gear).

Precautions while Driving:

- Do not use the gear lever as a hand rest. It may cause a Premature wear out in the gear selecting mechanism.
- Do not rest your foot on the clutch pedal while driving. It results in a premature wear out of the clutch system.
- Do not use half-clutch to hold the car still on steep roads. It wears the clutch. Always use the hand brake.
- Do not drive on heavy gears more than needed. Driving on heavy gears increases fuel consumption and sound volume. Lighten the gear as soon as possible to avoid damaging the engine.

Reverse Gear Warning System

The system lets you have a reliable, simple and exact parking in all conditions and situations.

How it Operates

A reverse gear sensor is installed in the rear bumper, and it is activated when the car is on reverse gear, and informs the driver of obstacles by sounding the horn. The shorter is distance between the obstacle and the car the higher the sensitivity of the system, and horn sounds are heard more frequently to inform the driver of the situation.

- System Specifications

The system in Samand SOREN contains two optical sensor installed in rear bumper.

- The existence of an obstacle in three regions with 46, 92, 138 cm distances and being visible by the sensors, will trigger different

warning signals from outside of the third zone towards the sensors as follows:

- Zone1: up to 46 cm, continuous sound of horn
- Zone 2: 46 to 92 cm, 3 sounds a second (frequency of 3)
- Zone 3: 92 to 138 cm, 1.5 sounds a second (frequency of 105)
- Zone 4: 138 cm and more, no alarm.

Error Warning When the Sensor Circuit Is Cut

- Warning if the left sensor circuit is cut
TiTiTiTi..... Ti.....TiTiTiTi
- Warning if the right sensor circuit is cut
TiTiTiTi.....TiTi..... TiTiTiTi
- Warning if both sensor's circuits are cut
TiTiTiTi..... TiTiTiTi

Sight radius of sensor is according to the following table:

Distance Between Object and Sensor	Detection Angle Range
1.0 feet's	40 deg. To 140 deg.
1.5 feet's	55 deg. To 125 deg.
2.0 feet's	60 deg. To 120 deg.
2.5 feet's	65 deg. To 115 deg.
3.0 feet's	70 deg. To 110 deg.
3.5 feet's	75 deg. To 105 deg.
4.0 feet's	80 deg. To 100 deg.

Technical Specifications:

Power: 8 to 16 volt system

Current flow: 50 mAmp on warning, 20 mAmp on stand by
temperature range, -30 to 85 °C

Humidity: Max 98%

Sensor stimulation frequency: 40 KHZ



- Troubleshooting the System

If any of the sensors are cut out, or defective, the system diffuses a different horn sound from the three ones mentioned above. In this case, refer to an authorized workshop for repair

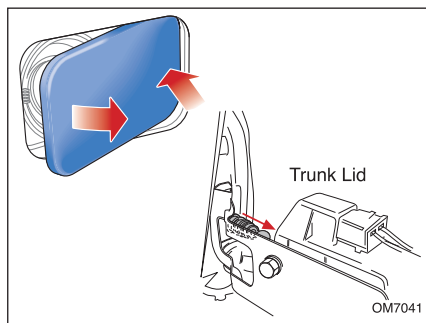

Fuel Filler Flap

The fuel filler flap is located on the right mudguard, and is linked to the central locking system.

When the central locking system is unlocked, push the right side of the flap towards inside to open.

NOTE: The fuel flap is only locked by the central locking system.

OPENING THE FUEL FILLER FLAP IN EMERGENCY SITUATIONS

- If the central locking system does not operate, you can open the flap from inside the trunk.
- Remove the upholstery of the inner right wall of the trunk.
- Pull back the tongue of the fuel filler-flap lock.

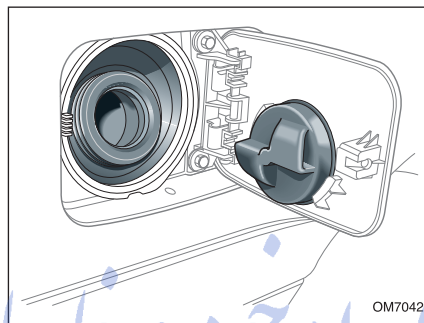

Fuel Filler Cap

Unscrew the filler cap counter clockwise, and wait a moment before removing the cap so that the gas inside the tank could exit. Place the cap in the holder provided on the flap.

Refer to the label inside the fuel cap to be informed on the type of usable fuels.

NOTE: The utilizable gasoline in engines XU7JPL3 is unleaded gasoline octane 95. If any other fuel is consumed, it is possible to damage internal parts due auto-ignition phenomenon and impact

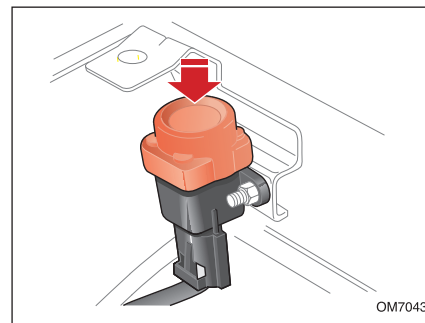

Fuel Cut-Off Switch

It is located in the engine compartment, and on the right inner mudguard.

During violent accidents, a safety system prevents fuel reaching the engine.

After you ensured that no fuel is leaking, press the key to open the fuel flow to the engine.

Since the gas in the fuel tank maybe under pressure, never open the fuel cap suddenly in order to prevent danger. Loose the cap slowly and carefully till the HISS sound stops, and then open the cap fully.

Considering the danger of gas mist, never fill the fuel tank while the engine is running. Please keep away of any sparkles, flames ...near the spilt gas

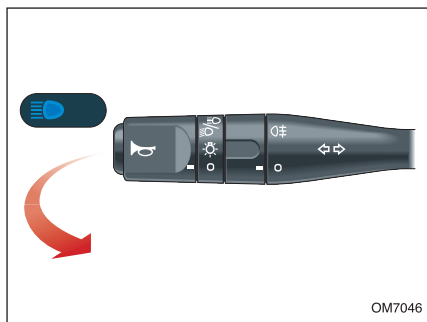

OM7046

Headlight Main / Dipped Beams

Put the lever completely towards the steering wheel to change headlight beams (BLUE warning light glows when the headlights are on main beam)

To flash headlights, pull the lever part way towards the steering wheel and release.

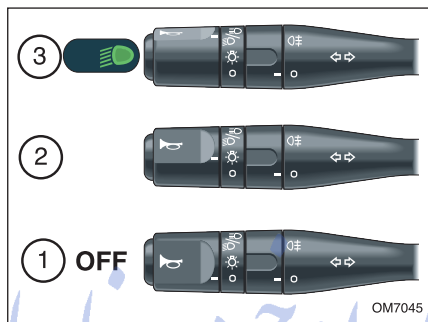

OM7045

Lighting Control Switch

Position 1: lights off

Position 2: Side, tail and instrument panel lights

Position 3: Headlights on

Warning Alarm

When the driver exits the car, it warns the driver that head lights are on, and it sounds if one of the doors is open and the switch is off.

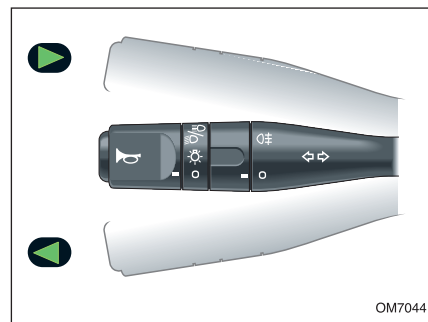

OM7044

Direction Indicators

Move the lever DOWN to indicate a LEFT turn, and UP to indicate a RIGHT turn (the appropriate GREEN warning light in the instrument panel will flash in time with the direction indicators).

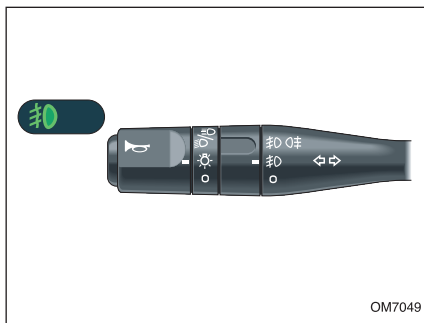

Front Fog Lights

Rotate up one level the center part of the stalk to turn on the front fog lights. The warning indicator on the instrument panel lights up simultaneously when fog lights are on.

The lights operate only when the front main headlights or indicator lights are on.

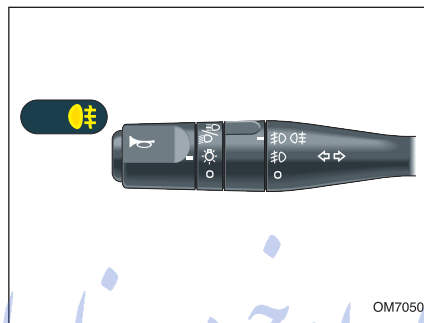

Rear Fog Light

Rotate up two levels the center part of the stalk to turn on the rear fog lights. The indicator on the instrument panel lights up when the fog lights are on. The lights operate if:

- main headlights or indicator lights are on
- The sidelights and front fog lights are on (if they are installed)

Fog lights should be used only when the visibility area is severely limited since drivers get dazzled when using fog lights in normal conditions.

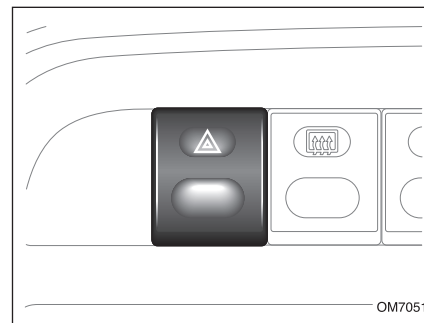

Flashers

Press the button to operate. All the direction indicators and the direction warning lights on the display panel will flash together. Use the flashers only in emergency situations to warn others that you are in danger, or when your car is causing an obstruction. The light keeps flashing even when the engine is off, so turn the light off at the end of the emergency situation.

For reminder if by any reason there is a sudden speed fall, the warning system will activate the flasher unit for 10 seconds.

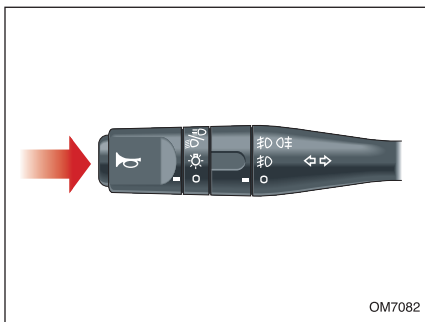

Horn

Press the end of the stalk to sound the horn.



Headlamp Adjustment (Headlight Leveling)

Level the headlight beam according to the load condition of your vehicle. In default position, the headlamp beam is adjusted on 0, parallel with the horizontal level. Horizontal aiming must be performed before making any adjustment to the vertical aiming. Please be aware of The load increasing on the back of the vehicle, which may cause lifting up of the car (angle from a horizontal surface). Therefore to remove the problem, use positions 1, 2 and/or 3 proper to the weight of the load to make a wider angle to provide light for driving on the road.

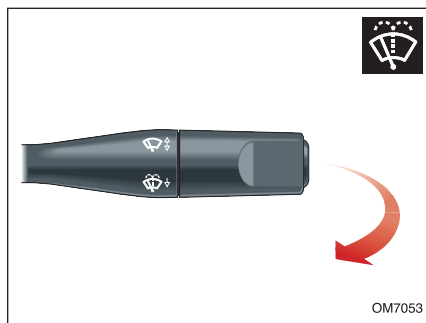

Screen Washer

Pull the lever backward to wash the screen; every time you pull the lever, the wipers operate 3 times.

As long as you keep the lever pulled, the screen washers will continue operating.



Single Wipe (only one reciprocating movement)

Pull the lever downward once and release it for a single wipe.

The wiper operates continuously when holding the stalk down.

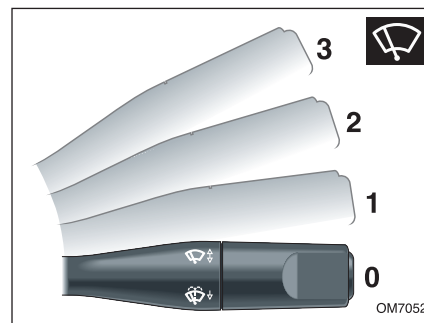

Windshield Wiper

The windshield wipers and screen wash functions are controlled by the right side stalk, and operate only when the switch is on.

0- off

1- Intermittent wipe

2- Slow speed wipe

3- Fast speed wipe

FarmaSOS.com



: When parking on a steep area move the wheels towards the sidewalk and pull the handbrake.

Foot Brake Servo Assistance

The braking system is servo assisted. It is activated only when the engine is running. A greater effort is needed to stop the car without using the servo system, and in this situation the vehicle will stop in a longer distance. Always consider the following points:

- Never run on neutral gear or with the engine turned off
- Always take care when towing the car with the engine turned off.



: When the (!)(P) and STOP icons are lit it means that the handbrake hasn't been released or is incompletely released.

If the engine goes off while driving, considering safety precautions bring the car to a proper place, and avoid unnecessary braking. It finishes the remaining available servo-assistance.

Caution: If the engine is not running, the brake servo assistance will not work; more pressure has to be applied on the brake pedal. In this case the stopping distance of the car will increase. Before moving the car, consider all necessary precautions.

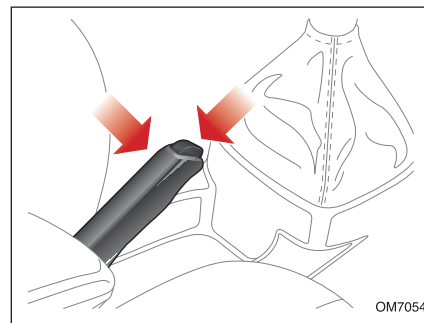

Handbrake

Handbrake locks only the rear wheels. Pull up the lever to use the handbrake. When parking, the handbrake should always be completely pulled up (without pressing the button on the lever). To release the handbrake, pull the lever up slightly, press the button on the brake, and fully lower the lever. The warning light on the instrument panel turns off when the handbrake is completely released.

When parking on a steep road facing uphill, use forward gears (i.e. one), and use reverse gear when facing downhill.

Anti-Lock Braking System

Anti-lock braking system is one of the car control systems preventing the wheels from locking on slippery roads, or intense braking. Therefore, it reduces the brake distance, steer ability, improves stability, and increases car safety in general. If the wheels slip, when braking, not only the brake distance increases but also the car control is endangered. Therefore, using the anti-lock braking system (ABS) system is necessary in this situation. It prevents fully locking of the wheels, and lets the driver to control the vehicle when making sudden and intense brakes. The system has a considerable effect on increase safety since it controls and adjusts the braking pressure electronically, and adapts itself to variations in road surface.

In the conventional hydraulic brakes, a timely constant pressure is applied to the brake pedal, and causes to lock the wheels on braking.

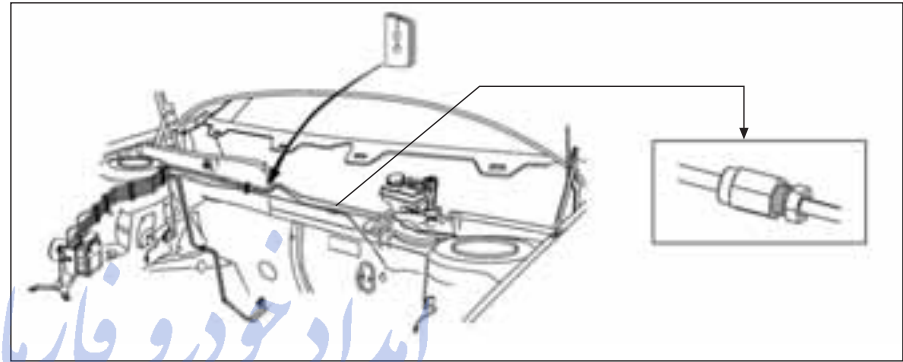

New navigation and stability system such as ABS prevent wheels from locking in these situations, which may cause critical driving situations. ABS actually monitors each of the wheels, and it can adjust braking pressures so that each wheel gets the maximum possible braking force without locking of the wheel while functioning. It prevents continual locking and slipping of tires, and can provide the best braking conditions for the vehicle to remain stable and controllable especially on slippery roads.

It is possible to summarize the advantages of the anti - lock braking system (ABS) as follows:

- 1- Ability to maneuver and maintain the stability of the vehicle when braking (on direct paths and while changing direction)
- 2- Sustained steerability during braking (on direct paths and while changing direction)
- 3- Reducing the burden of responsibility regarding the driver
- 4- Preventing the wearing of tires due to impeding repeated locking of the brakes and slipping of tires.

When using a car equipped with anti lock brake system always consider the following points:



- Since the anti lock brake system is only for balancing the braking force, therefore when braking sufficiently press the brake pedal and always follow safety guidelines.

- Feeling brake pedal vibrations under the foot while braking over unstable roads or sudden braking is normal and caused by the operation of the anti brake system.

- To hear noise when braking over unstable roads or sudden braking from front and rear wheels is normal and due to the operation of the anti brake system.

- The anti brake system is equipped with an automatic defect finding system that will light the anti lock brake system warning indicator  on the front panel display in case of a problem.

- When the car is turned on, the anti- lock brake system warning indicator  on the front panel display is on and will turn off after a few seconds. If the warning indicator does not light when the car is turned on or remains lit, is a sign of problem in the anti lock brake system. In this situation the car should be directed to an authorized workshop with precaution.

- If the handbrake is completely released the handbrake indicator  and anti lock brake system warning indicator  are both lit on the front panel display, stop the car with precaution and contact an authorized workshop.

FarmaSOS.com

Electronic Brake Force Distribution System (EBD)

EBD system balances braking forces ratio over rear and front wheels, and prevent over braking on rear-axis wheels. The system provides an optimizing and an ideal distribution ratio of the brake force between rear and front axes, and then can provide the best braking force ratio on each wheel to maximize best brake performance. Also by using the EBD, the pressure valve of the vehicle will be no longer needed.

ABS system, immediately prevents locking the wheel in sudden braking, and EBD ensures the optimized braking distribution on the wheels. When you use a car equipped with anti-lock braking system, consider the following:

In the case of any problem in EBD system, an alarm sign display on panel.

Airbag System

Supplemental Restraint System (Airbag)

Airbag system is designed to reduce the risk of injury. In this system the electronic controlling system detects the impact of the collision very quickly; then the air bags will be inflated with greater force, faster than the blink of an eye, and make a virtual secure place between the occupant and vehicle. In a low - speed frontal crash, only safety belts help keep you in a position before and during a crash. The driver's air bag is in the middle of the hydraulic steering wheel.

The right frontal passenger's air bag is in the instrumental panel on the passenger's side.

امداد خودرو فارما

تلفن شبانه روزی: ۰۲۱-۸۸۸۶۲۰۸۵

FarmaSOS.com



Airbag is located in the front steering wheel.

Air Bag Inspection:

There is an air bag readiness light on the instrument panel, which shows the air bag symbol. The system check the air bag electrical system for malfunctions. If there is an electrical problem, the light will flash more than once or remain. Have the air bag system inspected by an authorized IKCO dealer as soon as possible

Make sure the air bag light blinks or comes on only for six seconds when the ignition switch is turned to the "ON" position so you can check if the light is working.

CAUTION: Always wear your safety belt, even with air bags. In fact air bags are "supplemental restraints" to the safety belts. All air bags are designed to work with safety belts, but do not replace them. Air bags will activate only when the vehicle switch is on.

NOTICE: Releasing gas from inflated air bags, may cause a little bit inching.

Comment: The air bag icon on the instrument cluster will be turn on for 6 second after starting the vehicle 

CAUTION: If the AIR BAG light on the instrument cluster does turn off after 6 second when the ignition switch is first turned to the "ON" position, or the AIR BAG light stays on, or comes on while driving, the air bag system (or the seat belt pretensioner system (if equipped)) may not work properly.

Have the air bag system inspected by an authorized IKCO dealer as soon as possible; Otherwise, in the case of any probable damage, IRAN KHODRO will not take any responsibility.



امداد خودرو فارما

تلفن شبانه روزی: ۰۲۱-۸۸۸۶۲۰۸۵

FarmaSOS.com

3-VEHICLE MAINTENANCE

Maintenance

Engine Compartment

Engine

Cooling System

Brakes

Hydraulic Steering

Battery

Windshield Washer and Wipers

Tires

Cleaning and Caring the Vehicle



Safety in the Garage

If you need to carry out maintenance, consider the following safety advices:

- Keep away your hands and clothing from moving belts and pulleys.
- If the engine has been turned off recently, do not touch the exhaust, cooling system and its auxiliaries.
- Do not touch electrical connections or its other components when the engine is running or the switch is on.
- Never leave the engine running or start in a closed place since exhaust emissions are poisonous and very dangerous.
- Do not work underneath the car when jack is the only means of support.
- Ensure that bare wires and all sparking tools are away from the engine.
- Use protective clothes and impermeable gloves for maintaining operation.
- Put off the metal wristbands and jewelry before working in the engine compartment.
- Prevent tools or metal objects contacting battery poles and terminals.

Poisonous Fluids

All fluids used in a car engine are poisonous and should not get any contact with open wounds. These liquids include battery acids, anti-freeze, brake and hydraulic fluids, gasoline, oil and the washer additives. Pay attention to instructions written on the labels and containers filled with these fluids.

Caution:

The cooling fan is an electrical device, and may continue operating for a few minutes after the vehicle has been turned off. Keep out of the operating fan when working in the engine

Note: A long contact with engine oil may cause serious skin disorders as dermatitis and cancer. Wash your skin carefully if contacted.

Routine Services

The safety, reliability and performance of your car is partly dependant on your maintenance skills, and you should become ensured that maintenance operations, oil services, checks, brake fluid and coolant topping up are carried out in accordance with the proposed schedules of the manufacturer if required.

Brake Fluid Replacement

It is necessary to replace the brake fluid every two years, irrespective of the distance the car has run. It is foreseen to replace brake fluid in periodic services. If the replacement due time of oil and brake fluid are near to each other, the representative carries out services, oil and brake fluid replacing simultaneously, and you do not need an additional visit.

Note: Replacing brake fluid makes additional cost

Replacing the Coolant

The engine liquid coolant should be replaced every 2 years, irrespective of the distance the car has run.

The coolant resists freezing down to - 30 degree centigrade. The representative replaces the coolant in time to the service or oil replacement due dates if they are near to the conclusion of the two year period.

Note: replacing the coolant makes additional costs.

FarmaSOS.com

تلفن شبانه روزی: ۰۸۵-۸۸۸۸۸۸۸۸

Opening the Hood

- 1- Pull the hood release from the passenger compartment (driver side). The hood gently jumps up.
- 2- Pull the hood safety catch, and raise it up.
- 3- Pull out the hood port rod from rear engine retain
- 4- Fix the support rod into the slot fitted in the hood.

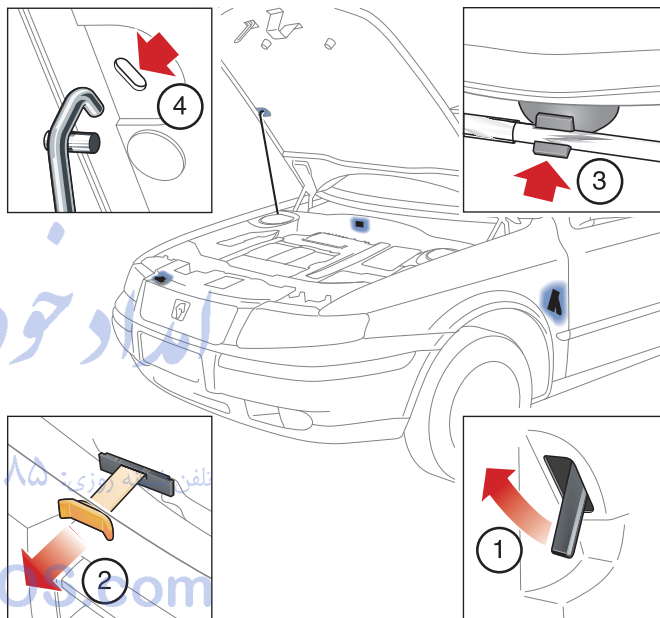

Closing the Hood

Replace the supporting rod in the retain clamp. Then lower the hood, and drop it from some 30 centimeter height. Check that the locks is fully engaged by trying to lift the front edge of the hood. It should be free of any movement.

OM7055

The Parts in the Engine Compartment

- 1- Brake Fluid Reservoir
- 2- Oil Dipstick
- 3- Oil Filler Cap
- 4- Washer Reservoir
- 5- Cooling System Valve
- 6- Battery
- 7- Hydraulic Fluid Reservoir

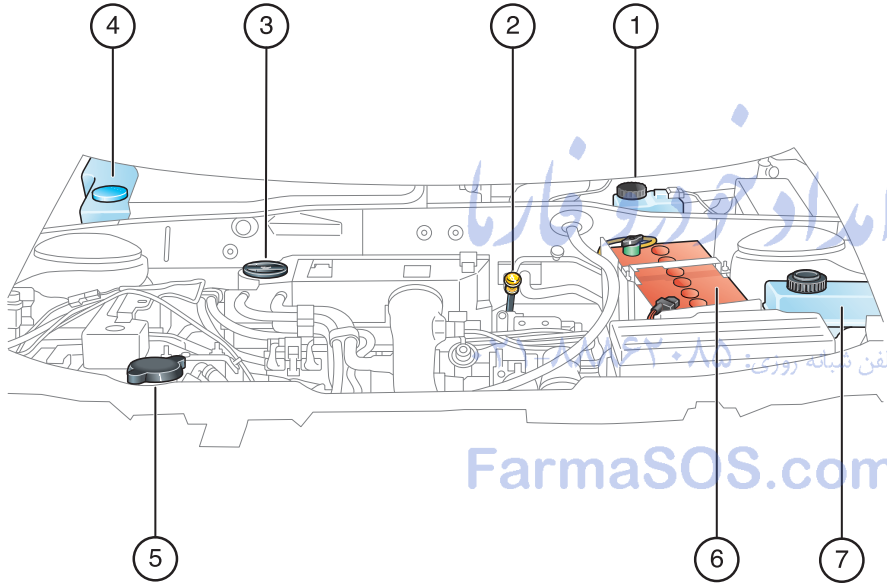

Caution:
Consider safety precaution on
previous pages when working in the
engine compartment.

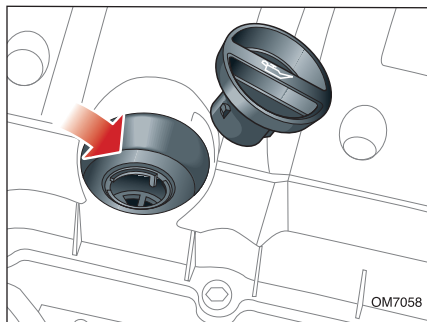

Engine Oil Fill

Unscrew the cap, and pour the oil in the reservoir. The oil level should never exceed (Max) marked on the oil dipstick. Refer to technical data section to be informed of the oil specification and the required volume.

Note : Never mix the oil with the added material, this can cause harm to the engine very seriously.

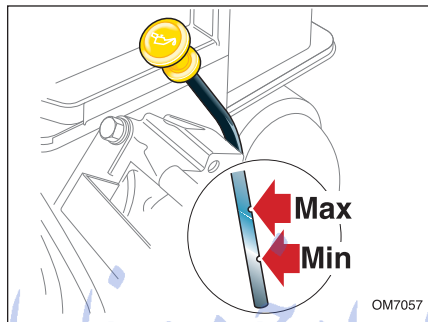

Checking Oil Level

Check the oil level every week or more time, when you extremely use the car. Check the oil level when the engine is cool, when the car is standing on a plane level, and the oil settles in the reservoir.

FarmaSOS.com

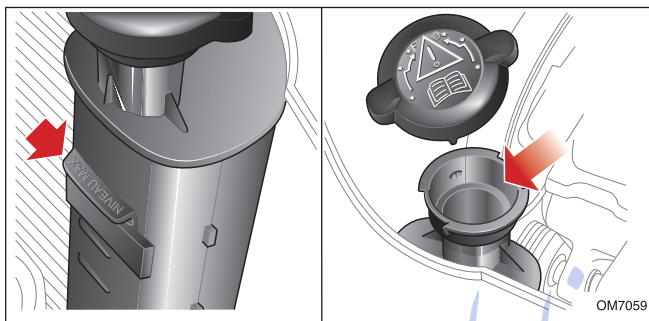

Checking the Coolant

The coolant level should be checked weekly when the cooling system is cold, and the car resting on a plane level. Liquid level should stand between (Max) and (min) signs on the vertical wall of the radiator (next to filler cap). Top up the radiator on necessity.

Filling the Radiator

If the engine is warm, wait 15 minutes until the engine temperature falls below 100 C. Protect your hands with a cloth and unscrew the filler cap carefully and slowly to the safety stop, letting radiator pressure fall.

Note: If more than one liter is needed to top up, an authorized representative should check the cooling system. Make sure that it is fully tightened to the second thread.

In an emergency, and only if the recommended anti-freeze is not available use clear water to fill the cooling system, but be

noted that it reduces coolant freezing protection. Always use anti-freezes with the recommended formulas. Consult with an authorized dealer.

Important Note: Cooling system draining and refilling are service operations that need sufficient knowledge, and should be carried out by qualified personnel according to the instructions of the repair handbook.

It is necessary to replace the coolant every two years. The coolant resists freezing down to - 30 degree centigrade.

Anti-Freeze

Anti-Freeze contains corrosion inhibitors. Anti freeze content of the coolant should be maintained between 40-50%, not only in cold weather but also all the year.

The anti-freeze content should be check once a year by the authorized dealer to make sure that the coolant has retained its anti-corrosion property, and replace the coolant completely every four years irrespective of the distance running

Caution:

Anti-freeze solution is poisonous, and could be fatal if swallowed. Keep it sealed and out of children's reach. If you suspect of drinking it, refer to the physician immediately. Prevent anti-freeze solution contacting with the skin and eyes.

If you accidentally get it in your eyes or on your skin, flush the place with water and get medical help immediately.

Brakes

Your car's most important safety section, the braking system is equipped with disc brakes in front and drum brakes in rear, and a with dual hydraulic circuit. When the engine is running, the brake assistance reduces the power needed to press the pedal.

Brake Fluid

The level of fluid may fall continuously and need a top up brake pad wears. If you find any noticeable oil level drop in a few times, refer to the authorized dealer. Do not drive if the level falls below the minimum sign in the reservoir.

Brake fluid should be completely replaced every two years.

Replace the brake fluid in the humid water any 20.000 km.

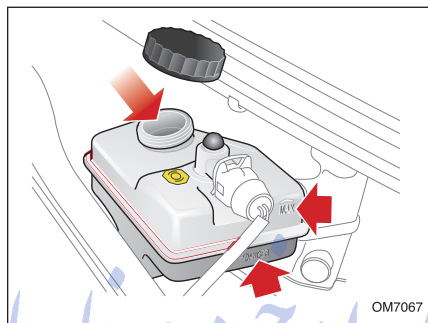

Checking the Brake Fluid

Clean the filter cap completely to prevent dirt entering the reservoir. Unscrew the cap, and fill up to the mark " MAX ". Do not let the fluid level drop below the mark " MIN ". Use only fresh seal contained fluid.(Only fluid from opened container, or fluid previously bled from the system absorb moisture, and if you top up them, can adversely affect the performance) . Do not overfill the reservoir Use standard liquids.

Caution:

Brake fluid is highly poisonous, and should be kept out if children reach.

Refer to the physician if the fluid swallowed.

Caution:

Prevent the fluid contacting the hands and eyes. If there is a skin contact rinse immediately with plenty of water. Rinse and then refer to the physician if contact with your eyes.

NOTE: Do not let the fluid spill over the warm engine since it may cause fire.

NOTE: Brake fluid damages the painted surfaces. Soak up spillage with a clean cloth, and area with water and car shampoo.

Hydraulic Steering

If the hydraulic steering is correctly operating there is few or no need to top up the reservoir. If there is a sudden or continuous level fall, the car should be checked by an authorized dealer. If the fluid falls below the mark minimum, fill it before starting. Otherwise, the steering pump becomes damaged.

When the level falls below the lower mark, or the level falls suddenly and rapidly, never use the lever. However if you find few losses, you can top-up to the upper mark, and run a short distance to the nearest authorized work place.

Every week, check the fluid level. The engine should become cold and switched off when checking hydraulic fluid level and front wheels should be straight.

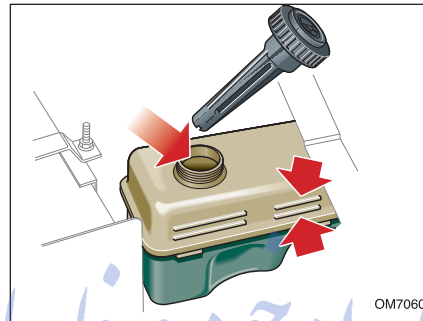

Checking the Hydraulic Fluid

Clean the filter cap completely to prevent dirt entering the reservoir. Unscrew the cap; clean the dipstick with a clean and lint-free cloth.

Dip it fully and remove again to check the level. Top up until the level reaches between the signs minimum and maximum. Do not overfill the reservoir. Refer to the chapter technical data be informed of specification of the recommended fluids.

If there is a skin contact, rinse the area with a plenty of water. Do not let the fluid spill over on warm engine since it may cause fire. For information on the

advised specifications of oil, refer to the technical information section. In case of hydraulic fluid contact with skin or eyes, rinse well with plenty of water. Due to fire hazard, make sure the hydraulic fluid does not spill on warm engine.

Caution:

Hydraulic fluid is highly poisonous, and should be kept out of children reach. Refer to the physician if accidentally swallowed.

NOTE: Brake fluid damages painted surfaces. Soak up any spillage with a clean cloth, and wash the area with water and car shampoo.

Caution:

Batteries contain acid, which is corrosive and poisonous. Consider the following points on leakage: If it spills on your clothes or skin, immediately put off the contaminated clothes, and flush the contacted skin with a lot of water, and refer to the physician.

-In an eye contact immediately, flush it with clean water for at least 15 minutes, and refer to the physician urgently.

-It could be fatal to drink battery acid, if medical attention is not immediately taken.

-Working batteries emit explosive gases; keep away fire and sparks from the engine compartment. Put off the metal wristbands and jewelry before working in the engine compartment. Never let tools or metal object contacting battery poles and terminals.

If the car stops more than 6 days, it should be switch on at least one time and for an hour.

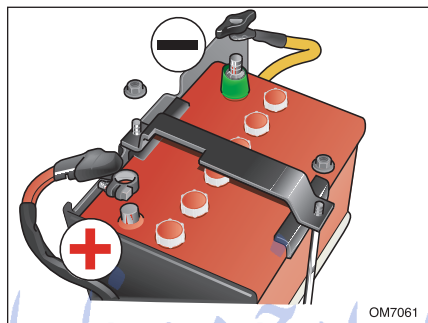
**Detaching the Battery**

Turn off the alarm before disconnecting the battery, and make sure that the ignition switch is off. At first, detach negative cable (-) and then the positive (+) cable. Attach the positive cable and then the negative cable on to reconnect the battery. Do not let the battery poles have any connection with the bodywork or metal parts. Unscrew the nuts supporting battery clamps, and then take the clamps to remove the battery. When replacing fit the battery and its clamps right in position (the poles towards the engine), and then tighten the nuts of the clamps so as to stabilize the battery unit, while avoiding over tightening of them.

Replacing Battery

Always use batteries of the same type and of the original specification. Other types may vary in size or terminal positions, which may have fire danger when connecting to the car electrical system.

Notice: Do not charge battery when connected to the car. This could seriously damage the electrical system.

Important: It is better to check the distilled water and acid level once a month if the battery lids are removable. If the level is less than recommended, the needed amount should be added.

Caution:

-Do not change the battery suspected of being frozen.

-Take sparks and fires away from the battery when charging (charged or incharge batteries generate inflammable hydrogen).

-After charging the battery and before connecting to the car, wait for one hour so that inflammable gases exit and therefore the risk of ignition is reduced.

SLI* Battery

Maintenance Free (non sealed)
The nominal ampere/hour capacity of a battery, is the amount of electricity delivered in 20 hours in a way that the voltage does not fall below 10/5 volts. C20=66Ah

Specific gravity	cold weather 1/28 gr/cc
	Warm weather 1/23 gr/cc

If specific gravity of the electrolyte falls below 1/2 gr/cc battery needs to be charged.

If battery voltage is low observe the following:

- 1- Inspection of the dynamo belt and its decomposition, in this case the alternator current falls.
- 2- Problem in the dynamo system, if the voltage in 0°C is higher than 15/1 volts the voltage regulator inside the dynamo is broken, in this case it is possible that the battery is overcharged therefore damage could occur to the battery.
- 3- Problem in the wiring system, the spark wire has to be tight and cable diameter has to be adequate.
- 4- Since in -18°C the effective starting current is 200 Ampere, therefore do not continue the starting process more than required. In case the decision has been taken to change the battery, it is more suitable to replace with a battery similar in size and amperage.

Battery's Common Problems:

- Decrease of the electrolyte covering 50% of problems and it is the result of heat and overcharge.
- Keeping the lights on causing a deep discharge.
- Non conformity of the replacement battery with the original.
- Low charge or lose dynamo belt.
- Additional vibration due to unfastened battery clamp.
- Use of un distilled water.
- Corrosion
- Freezing

*SLI= Starting, Lighting, Ignition

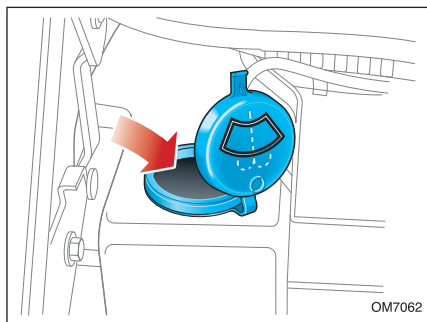

Filling the Windshield Washer Reservoir

Every week, check the reservoir liquid level. Fill the reservoir with a mixture of water and proper detergent to make sure that the screen is neatly washed and free of frosts. Mix the recommended quantities of water and detergent in a separate container and fill the reservoir. Always follow the detergent usage instructions.

Note: never use the mixture of anti-freeze and water in the wiper reservoir. It can damage vehicle color.

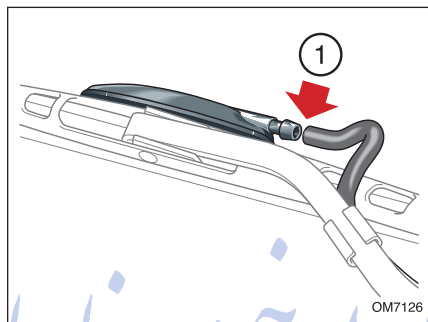

Removing Wiper Blades

1-Detach the sprinkling jet from the wiper hose.

Lift up the wiper arm and turn the blade so that it makes a 90 degree with the arm.

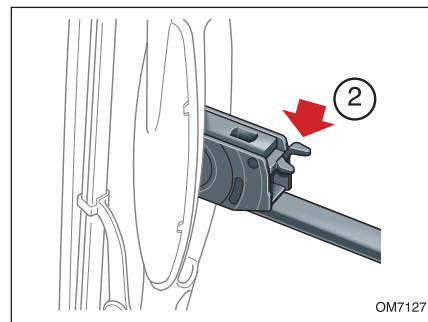

2-Press down the trigger tongue.

FarmaSOS.com

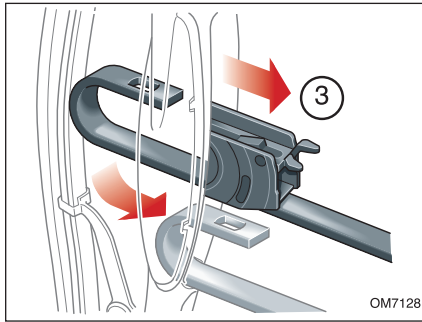

1. Press down the blade so that it detaches the catch, then pull out the blade.

Replacing the Wiper Blades

Replace the blades one by one, always leave one wiper assembly intact to act as a guide while replacing the other.

Grease, Silicon adhesives and oil products impair the wiping performances. Wash the blades with soap and warm water, and check the blade regularly.

امداد خودرو فارما

تلفن شبانه روزی: ۰۲۱-۸۸۸۶۲۰۸۵

FarmaSOS.com



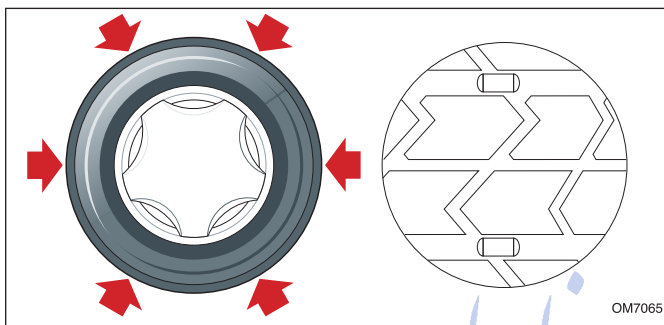

Tire Wear Indicators

Tires fitted on the car have wear indicators moulded into the tread pattern at several points around the circumference. When the tread has worn down to 1.6 mm, the indicators will come to the surface of the tread pattern. The wear indicators in the tread pattern show when the tires has reached its safety limit. For safety it must be replaced.

Protecting Tires

Always drive considering tires condition and check their crowns and sidewalls to find distortions (especially lumps and cuts).

Tires' Pressure

Check the tires pressure at least one a week when the tires are cold since the pressure rises when tires are warm. The recommended tire pressure can be found in the chapter "Technical Data".

Caution:

Never drive with wear out or damaged tires, or tires with unadjusted pressure.

- Low pressure tires wear off very fast and result in serious problems for the safety and control of the car.

Caution:

Always use the same make and type of radial-ply tires for front and rear wheels. Do Not use cross-ply tires, or interchange tires from front to rear.

Your vehicle is fitted with roads wheels that will NOT accept inner tubes. DO NOT fit a tube tire.

Punctures

The punctured tire should be removed, and checked exactly before repairing the puncture. It should be carried out by the qualified experts to prevent the risk of future damages to the tires.

Repairs should only be carried out by experts willing to bear the responsibility for the quality of the repair work.

Defective tires are dangerous! Do not drive with damaged, worn out, or over-pressured tires.

Cleaning the Bodywork

In order to preserve the car painting finish, please consider the following advices.

- Do not use hot water to wash the car.
- Use wet linen cloth to clean dirt and dust from the car metallic paint to prevent scratching.
- Do not use detergent powder or washing liquids.
- In hot weather, do not wash the car in direct sunlight.
- Do not flush the water directly to the windows, door liners or the brake components.
- Use a water hose to flush dust and dirt from the bodywork before washing, and when the car is too dirty. Then wash the car with cold water or lukewarm water and a good quality shampoo.

Use plenty of water to make sure that the bodywork has become free of dust. Rinse the car with clear water and soak up using a chamois leather cloth.

Cleaning The Underneath

Occasionally and especially in winter, flush away mud from underneath of the car such as the wheel compartment and frame gaps (seams), which can easily collect debris. Do not flush water directly to susceptible areas.

Use the following materials to wash the exterior of the vehicle:

- Car shampoo
- Wax polish
- Tar remover
- Glass cleaner
- Rubber protector
- Cleaner of rims and aluminum

FarmaSOS.com

Caution:

In some high pressure, water penetrates in doors and windows liners, and cause damages to the locks. Do not use high pressure water on sensitive parts

Removing Tar Spots

Use white spirits to remove the oil and tar spots stuck to the paint works. Then wash the area immediately with soapy water to remove all traces of the spirit.

Body Protection

Check the paintwork after you finished washing. Paint the area suffered chips or scratches using a touch – up pencils. If the body surface has been uncovered, first use a colored primer and then apply the correct color base coat and finish off with a lacquer pencil and polishes. This action must be performed after washing and before waxing or polishing.

Vast damages of the paintwork should be repaired in accordance with the menu fractures recommendations. Otherwise anti-corrosion guarantee is invalidated.

Contact an Iran Khodro authorized dealer for further information.

Polishing the Bodywork

Occasionally treat the paint works with an approved polish containing the following substances:

- Very mild abrasives to remove surface contamination without removing or damaging the paint.
- Filling compounds that fill or remove scratches on the body works
- Wax to provide a protective coating between the paint work and external particles

Wiper Blades

Wash the blades in warm soapy water. Do not use white spirit or oil based detergents.

Window and Mirrors

Regularly clean windows, inner and outer sides, with a good quality glass cleaner.

Windshield: Clean the windshield with glass cleaner after washing and polishing the car and before fitting new wiper blades.

Rear window: Clean the inner side with a soft cloth with a left and right movement. Avoid damaging the heating elements. Do not clean the window using abrasive detergents, it will damage rear window-heating elements.

Mirrors: Wash the mirrors with soapy water and use a plastic scraper to defrost the mirror surfaces.

NOTE: Avoid using abrasive cleaners or metal scrapers.

4-TECHNICAL EMERGENCIES

Changing Wheels

Starting Vehicle in Case of Emergency

Transporting the Vehicle

Fuses

Changing Lamps

Parts and Accessories

Warning Stickers and Tags

Identification Numbers



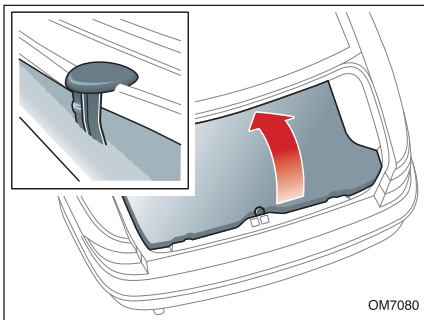

Spare Wheel and Its Tools

Remove the carpet from the bonnet floor by lifting up the handle provided. Hook up the handle on the trunk edge, under the rear window.

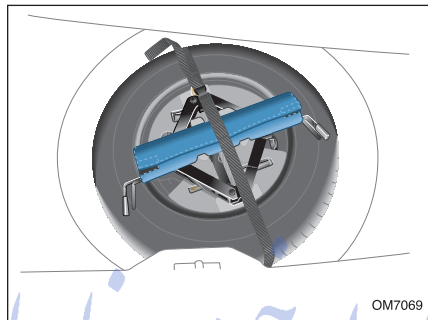

The Spare Wheel

Release the supporting strap, and remove the warning triangle and toolbox including the tools. Remove the spare wheel.

Hazard Warning Triangle

Put the warning triangle 50 to 100 meters behind the car beside the road when you have a break down or a wheel replacement and need to stop the car. The distance should be increased if there is an obstacle as the crown of a hill.

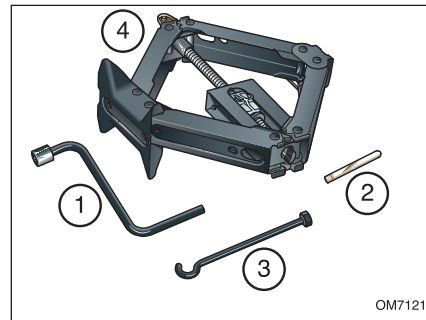

Tools

1. Wheel brace
2. Central nipple
3. Jack wrench
4. Jack

The toolbox prevents the floor carpet recession. Fasten the supporting strap to prevent tools and the spare wheel moving. In some models, other tools are provided for general repairs in a special compartment on the spare wheel.

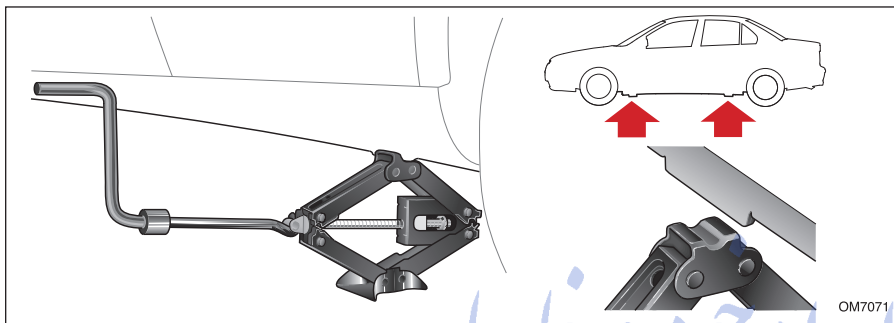

Positioning the Jack

Put the jack in one of four points to the wheel you decide to change.

- Make sure that jack rests on a plane level.
- Do not use a jack while passengers sitting in.
- Make sure that front tires are completely in direct alignment and the vehicle is in first gear.

Jacking

- 1-Slacken the wheel's four nuts using a wheel brace.
- 2-Fit the wheel brace to the jack wrench, put its ending hook into the jack ring, and turn it counter-clockwise to raise it.
- 3-Remove the wheel top nut and fit central nipple.
- 4-Raise the vehicle until it detaches the ground.
- 5-Unscrew other three nuts and remove the wheel.

Removing Aluminum Sport Rings:

The steps followed for replacing aluminum ring are very similar to metallic ring, only the wheel cover removal part is omitted.

Soren has got four aluminum rings and one spare part with a steel ring.

Caution:

Always try to choose a safe place away from the main traffic to replace the wheel. Take out the passengers to a farther safe area.

Caution:

Never work beneath the car when the jack is the only support. Jack is only for replacing the wheel.



- Use the centralizing tool as a guide to place the wheel.
- Screw the three other bolts, and tighten the fillet of the fourth one after removing the wrench.
- Tighten all 4 nuts
- Lower and remove the jack
- Tighten all nuts completely in a diagonal sequence.

Starting the Engine When the Battery Discharged

The only approved method to start a car with a discharged battery is to use jump leads to connect a donor battery or a battery from another car. Avoid pushing or towing to start.

Using Booster Cable

If you use a donor vehicle to start the engine, park both vehicles in a way that batteries locations adjacent to each other. Make sure the two vehicles do not have any direct contacts. Pull up the handbrake and make sure that the transmission of both vehicles is set in neutral. Turn off both car switches and electrical equipment. Then follow the next page instructions.

Caution:

- In normal conditions, batteries produce hydrogen gas that may explode and cause serious injuries, therefore avoid direct spark or fire on the engine compartment.
- When you suspect your battery of freezing do not start the engine.
- Make sure both batteries have similar voltage (12 volts) and booster cables are equipped with insulated clamps and are adequate to be used with 12 volts batteries.
- When connecting from battery to battery, do not remove the cable from the discharged battery.
- Never connect the positive pole to the negative pole and make sure the booster cables are separated from the moving parts of the engine.
- Be careful when working near the moving parts of the engine.
- Adding unauthorized electrical equipments could damage the electrical system of the car and cancellation of these parts guarantees.
- When starting the car by pushing, the timer belt could break

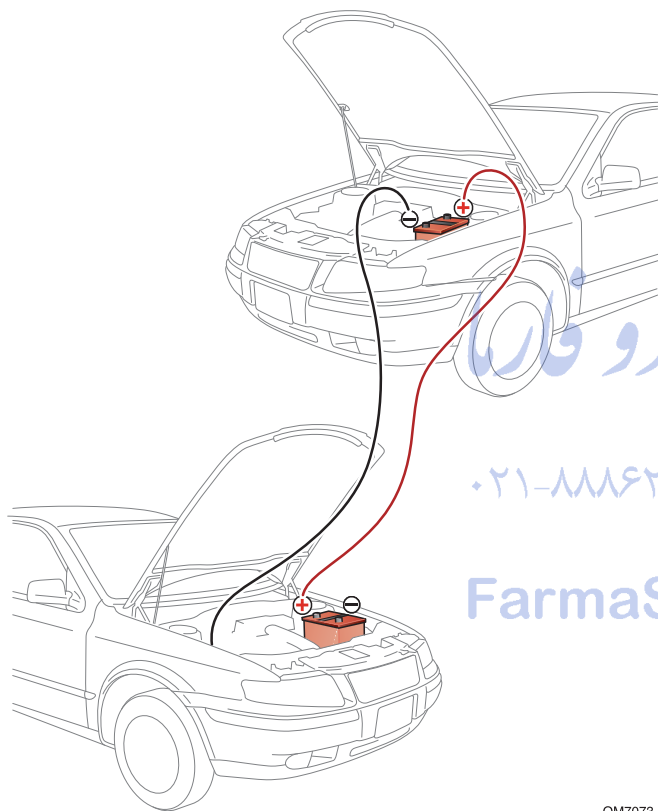

Connecting the Booster Cables

Always follow the instruction:

1. Connect the RED booster cable between the positive (+) terminal of the donor battery and the positive (+) terminal of the discharged battery.
 2. Connect the black booster cable from the negative (-) terminal of the donor battery to a connection point on the recipient vehicle's bodywork (e.g. an engine mounting or other unpainted surface) away from the battery, fuel and brake pipes, (as shown in the illustration).
 3. Make sure that the cables are far away from any moving parts of both engines, then start the engine of the donor vehicle, and let it idle for a few minutes.
 4. Now start the vehicle with the discharged battery. Once both engines are running normally, let them idle for 2 minutes before you switch off the donor vehicle.
- Do not switch on any electrical equipment of the recipient vehicle before disconnecting the booster cables. Detaching order of the booster cables is exactly reverse of the connection instructions.

Towing the Car

Caution:

- The vehicle on tow should be always lighter than the towing vehicle.
- The towed vehicle should never have any passengers.
- Remember that the brake servo does not operate when the engine is off, and you need much generator force to operate on the brake pedal.

Towing the car with a manual gear box (non-automatic)

Neutralize the gear and turn on the flashers.

Drive carefully and never exceed the speed limit of 50km/hr when being towed

Always keep the tow rope stretched by gently applying the brake as necessary. It avoids impact on the rope and its rupture.

- Get help from experienced persons to carry the car.

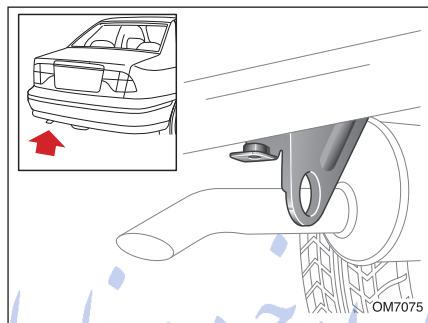

Front Towing Ring

Use the ring beneath the front bumper only to tow the car on 4 wheels.

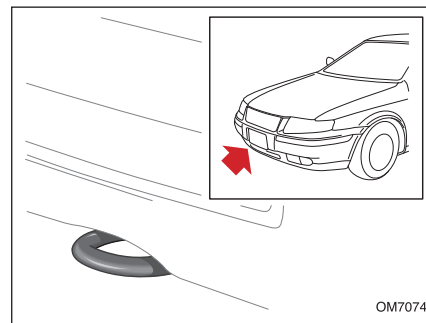

Caution:

Do not remove or close the starting switch when towing on four wheels, since it will block the steering wheel. Put the switch in A position.

Rear Towing Ring

The rear ring should be used only to tow cars lighter or with the same weight. Do not use the rings for suspending tows (on two wheels)

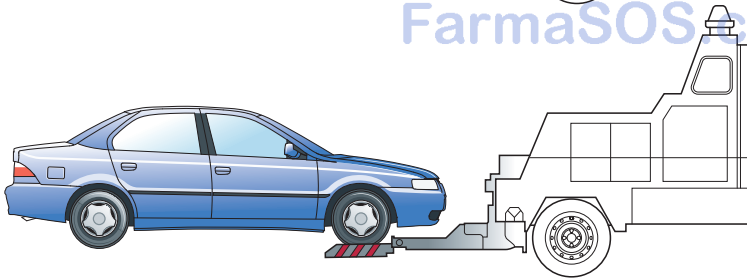
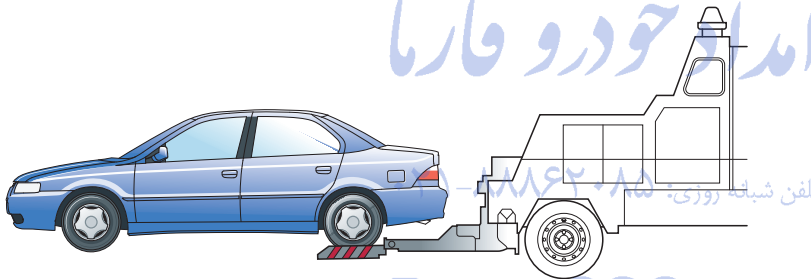
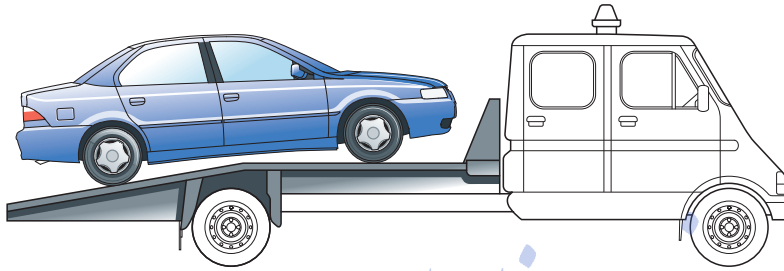

OM7078

Shipping by Carrier

This type of carrying is the recommended to prevent any accident or damage.

Rear Towing

Avoid suspension towing on front wheels if possible. If it is necessary, tow it at least speed and short distances. The steering should be locked when the wheels are completely ahead. Use supporting clamps or catches in addition to the steering lock.

Front Towing

The steering should be locked when the wheels are completely ahead. Use supporting clamps or catches in addition to the steering lock.

Caution:

When the car is being towed from the front and moves on back wheels, make sure the handbrake operating on the rear wheels is released.

FUSE BOX

The fuse box locates in left rear of the engine compartment near to the wiper electromotor. Remove the cover to get access the fuses.

Fuses

Fuses are simple circuit breakers that protect electrical equipment being damaged.

The supporting fuse may be burnt whenever electrical equipment does not operate.

Replacing Fuses

1. Turn off the ignition switch and all electrical equipment.
2. Remove the fuse box cover, and then find the defected fuse according to the table.
3. Take out the tweezers (located in the fuse box), and use it to pull out the defected fuse. A blown fuse can be recognized by a break in the wire.
4. Replace a blown fuse with another of the same or lower rating. Be aware that there are a number of spare fuses located along the lower side of the fuse box.

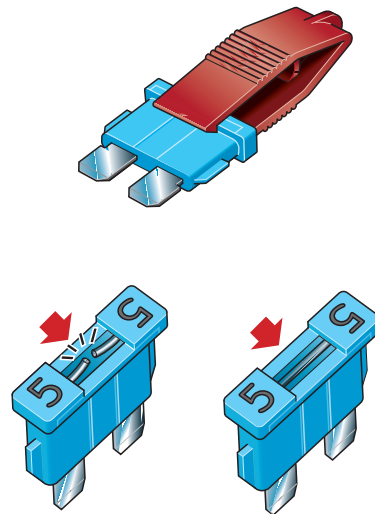
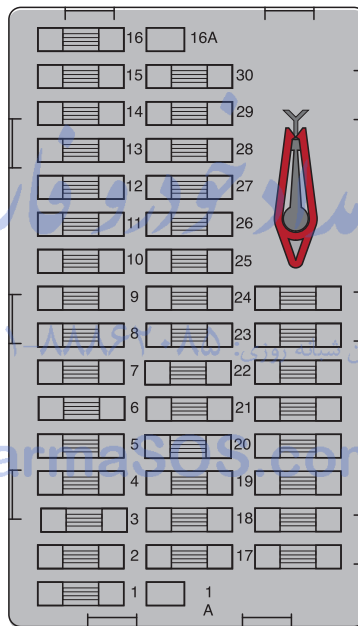

Fuses	Amper	Function	F16	20 A	Cigar lighter
F1	10 A	Radio	F17	10 A	Alarm, Anti theft system, audio system memory
F2	5 A	Control Unit	F18	10 A	Rear fog tails
F3	5 A	Anti lock brake	F19	5 A	Heater/ Display / Radio/ Switch lights
F4	5 A	Beep sound, right indicator lights	F20	30 A	Automatic backrest of front seat
F5	5 A	Air Conditioner	F21	30 A	Blower relay
F6	30 A	Anti lock brake	F22	10 A	Air bag
F7	20 A	Horn	F23	5 A	Rear window heater switch
F8	Shaunt	To disconnect all fuses	F24	20 A	Wiper motor/ timer / washer pump
F9	5 A	Left indicator lights, number plate light	F25	5 A	Radio/ Clock memory, Water Ampere(Coolant temperature unit)
F10	30 A	Electric Rear window regulator	F26	15 A	Flashers
F11	30 A	Front headlights	F27	30 A	Rear window heater, window heater
F12	5 A	Reverse gear lights, Rear sensors	F28	10 A	Instrument Panel Screen/digital clock/brake warning light
F13	20 A	Front fog tails	F29	30 A	Electrical Front window Regulator
F14	30 A	Anti lock brake	F30	10 A	Map Reading Light/ Glove Box/ Vanity mirror/Automatic mirror
F15	15 A	Door lights, courtesy lights			

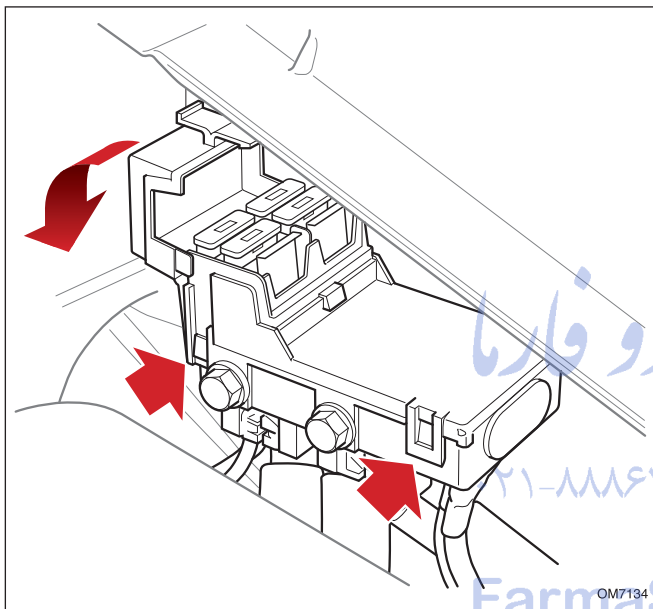

Engine Compartment Fuse Box

The fuse box locates in the right of the engine compartment. Detach clamps and remove the cover to access the box. Make sure the cover is correctly fitted when replacing the cover. Owner should not remove or replace fuse connections and all problems should be checked by qualified technicians.

Fuse Specifications:

F 31	30 A	Fan
F 32	30 A	Fan
F 33	Shaunt	Ignition Switch
F 34	Shaunt	Main Light/ Dipped Beam
	Reserve	Reserve
	Reserve	Reserve

Caution: The electrical system of your vehicle is designed standard or optional equipment. Consult an authorized dealer before installing other electrical equipment. Some electrical accessorier or the way in which they are fitted can have damaging effects on the operation of your vehicle; the electronic control circuit units, the audio system circuit or the battery changing circuit. Installing electrical equipment should be carried out by an expert.

Caution:

When transporting or when the car is not used for a remove the F34,F33 shaunts that connect the battery to parts consuming electricity, using pliers to avoid discharging battery. Obviously to resume the car you must replace the shaunt.

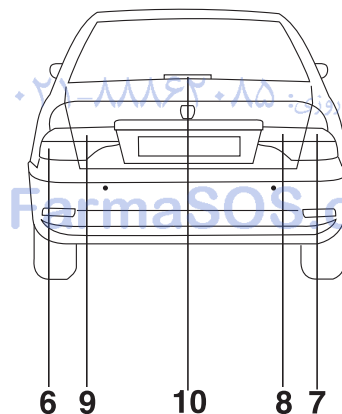
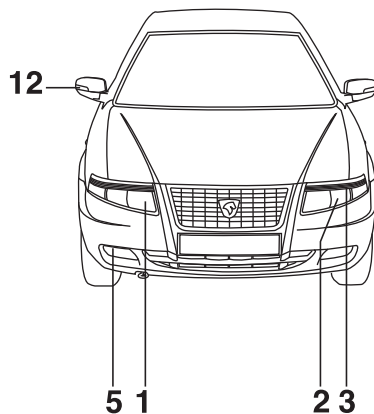

Replacing Bulbs

- 1- Headlight - Dipped Beam
- 2- Headlight - Main Beam
- 3- Side Light
- 4- Front Direction Indicator
- 5- Front Fog Light
- 6- Rear Light/ Brake Lights
- 7- Rear Direction Indicator
- 8- Reversing Lights
- 9- Rear Fog Light
- 10- High Mounted Brake Light (Upper Brake Light)
- 11- Side Repeater Light
- 12- Side Indicator Lamps

OM7100

Replacing Bulbs

IMPORTANT NOTE: Check all exterior lighting operation before starting driving.

Turn off the lighting switch when replacing the bulb to avoid short circuit.

Light	Watt
Headlight- Dipped Beam	55
Headlight -Main Beam	55
Side Light	5
Front Fog Light	55
Rear Fog Light	21
Indicator Lights	21
Side Repeater Lights	5
Reversing Lights	21
Rear Light/ Brake Lights	LED
Number Plate Light	5
Door Lights	5
Courtesy Lights	5
Boot Light	5
Glove Box Light	5
Vanity Mirror Light	5
High Mounted Brake Lamp	LED
Lamps Indicator Mirror	LED

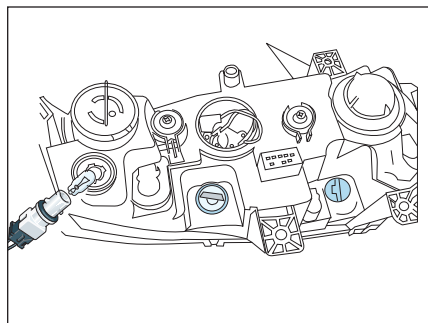

Side Direction Indicators (Sidelights)

There are three sidelight bulb connectors at the top of the headlamp unit.

1. Turn the connectors anti-clockwise to remove the lamp.
2. Pull the bulb from bulb holder.
3. Push in the new bulb and refit the connector.

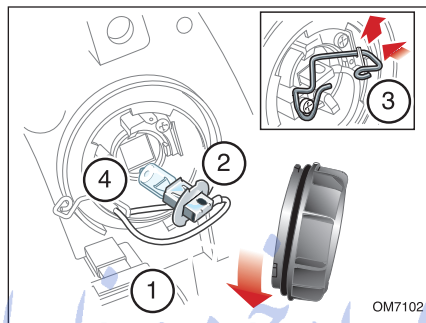

Headlamp Main Beam

1. Unscrew the cover
2. Detach the plug on the back of the lamp.
3. Remove the spring clamps
4. Connect the bracket, and adjust the bulb with the mark on the reflector and avoid touching the bulb glass. Then secure the spring clips.
5. Reconnect the earth lead.
6. Screw on the cover.

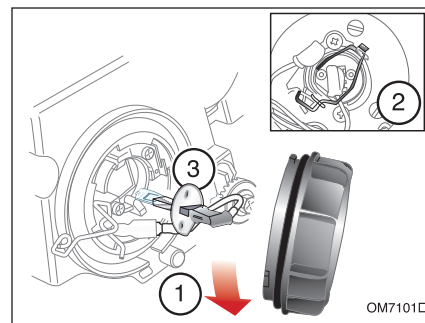

Headlamp Dipped Beam

1. Unscrew the cover
2. To remove the spring clamps, press it inwards and lift it up
3. remove the lamp
4. Detach the plug lead from the end of the lamp
5. Connect the bracket, and adjust the bulb with the mark on the reflector and avoid touching the bulb glass. Then place the spring clamps.
6. Screw the cover

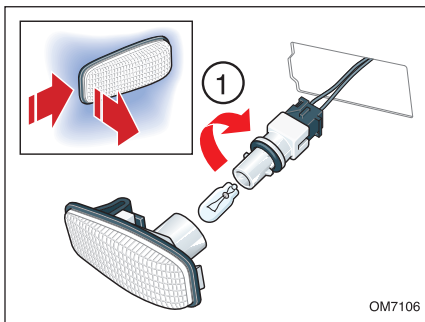

Side Repeater Lights

Push the light assembly frontward, and pull it out to remove. Hold the light cover carefully and turn the lamp holder. Remove the lamp from the holder and replace it. Put back the holder and turn it to fit. Replace the light assembly.

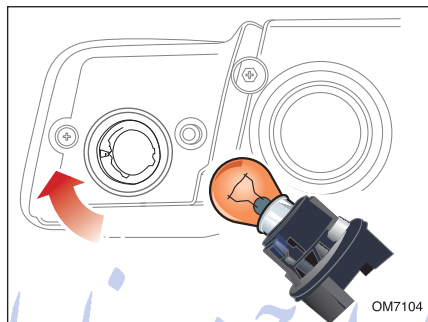

Front Direction Indicators

Turn the holder counter clockwise to become released, and remove it. The holder is of a bayonet type. Press it inward then turn counter-clockwise to remove. Replace the bulb.

FarmaSOS.com

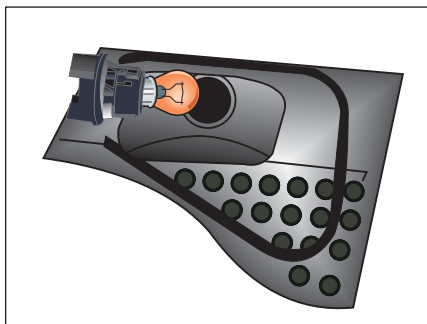

Rear Fog Lamps

Regarding modern vehicle, the lamp is located only on the left side of vehicle (Driver's Side)

The above mentioned lamps are mercurial and to change them.

Unlock the trunk lid, turn the holder counter- clockwise to release and remove it. Lamps have bayonets. Push towards inside and turn counter clockwise to remove. Replace the lamp and refit the assembly.

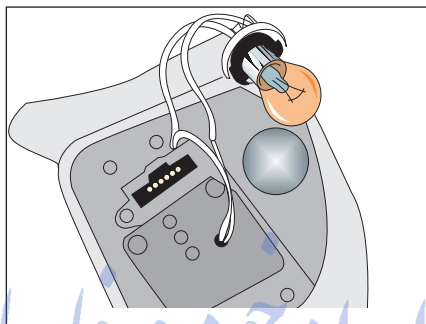

Rear Direction Indicator Lamps & Rear Brake Lamp

There is only one connector for rear fog lamp and rear director indicator. Turn the connector anti-clockwise to loose direction indicator. Then press the lamp clip to release the lights.

Brake Lamp and Reverse lamp have been located in Headlamp unit(LED). Rear lamps consist of 20 LED lamps. To change LED lamps, rear lamps assembly(on the bumper)should be changed completely.

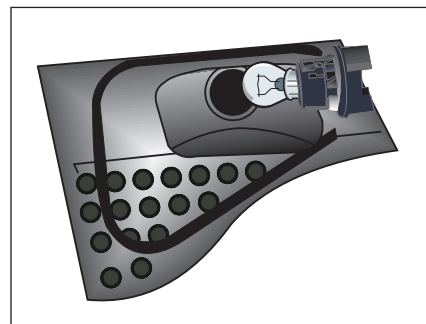

Reverse Lamp

Considering new tecnology in car manufacturing industry, there is only one reverse lamp at right (right front passenger side).

Open the trunk lid and turn the connector anti-clockwise.

Remove the bulb and its holder .Release bulb bayonet and remove it. Change the defective bulb and refit the bulb holder.

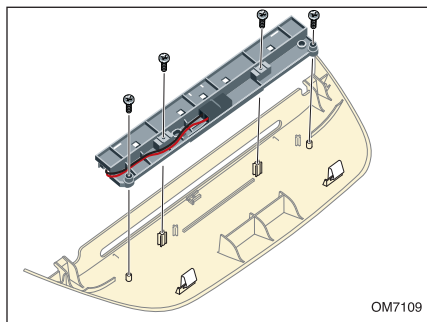

High Mounted Stop Light

Lift the rear part of the light cover, and pull it out of the rear shelf. Remove the connector. Turn the bulb to reach the holder four supporting screws. The assembly should be completely replaced. Refit the new assembly, and reconnect. Before fitting the rear clamps, make sure that front clamps are engaged.

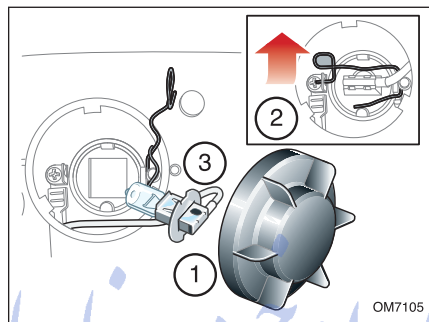

Front Fog Light

You can access the front fog tail through beneath part of front set.

- 1-Unscrew the cover
- 2-Press in the spring clamps, and lift it up to release
- 3-Remove the bulb, and disconnect the connector
- 4-Fit the connector, and place the new bulb without touching the bulb glass.
- 5-Align the bulb and the guide, and place the spring clamps
- 6-Refit the cover

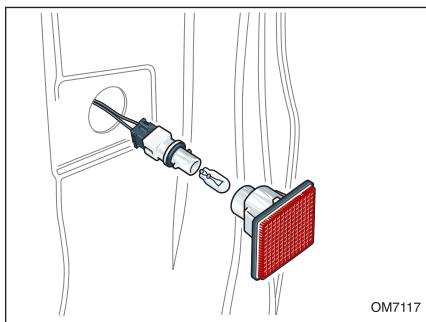

Door Light

Pull out the light carefully from the door. Turn the holder, and remove it. Detach the bulb from the bulb holder, and replace a new one.

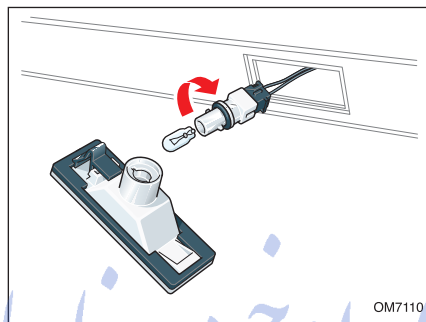

Number Plate Light

Push the light to the left, and turn it down to remove. Turn the bulb holder, and take it out and replace a new one.

تلفن شبانه روزی: ۰۲۱-۸۸۸۶۲۰۸۵

FarmaSOS.com

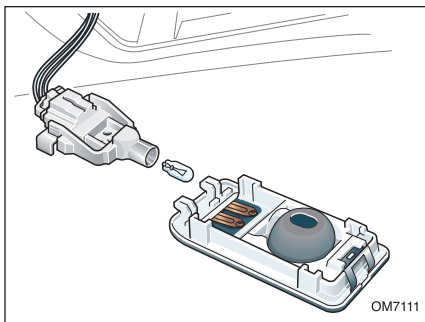

Front Courtesy Light

Insert a screwdriver carefully in the rear slot of the light, and lever to remove from the holder. Hold the light assembly, and open the holder. Take out the bulb, and replace it. Make sure that the holder is tightly placed, and then install the light assembly.



Map Reading Light

To replace map reading light, first unscrew the courtesy lamp cover and remove it. Loose the connector and turn the lamp anti-clockwise and then remove it. Replace the bulb again and refit the light unit.

FarmaSOS.com

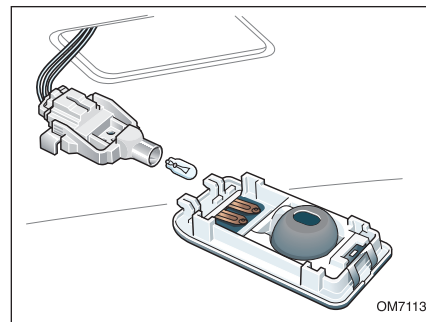

Rear Courtesy Light

Insert a screwdriver carefully in the rear slot of the light, and lever to remove from the holder. Hold the light assembly, and open the holder. Take out the bulb, and replace it. Make sure that the holder is tightly placed, and then install the light assembly.

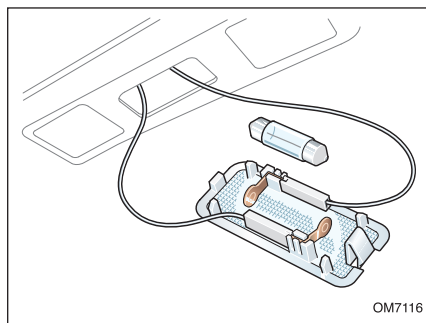

Trunk Light

Insert a screwdriver carefully into the light rear slot. You can access the bulb by removing the transparent lid. Detach the bulb from two connection points. Replace the bulb, and refit the lamp.

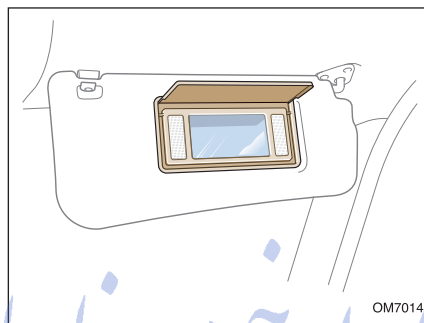

Vanity Mirror Light

The bulb cannot be replaced. Buy a new replacement sunvisor from an authorized dealer.

تلفن شبانه روزی: ۰۲۱-۸۸۸۶۲۰۸۵

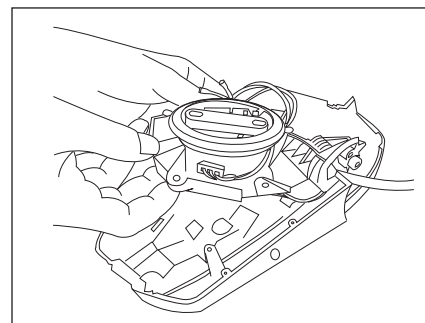

Side Lamp Mirror

First release the side mirrors colored glass bayonet, then unscrew the side mirror engine and its cover. At the end unfasten 2 LED screws and remove them. Replace the new LED.

FarmaSOS.com

5-TECHNICAL INFORMATION

Warning Labels and Plates

Identification Numbers

Engine Technical Information

Weights

Vehicle Dimensions

Anti-Pollution System



امداد خودرو فارما

تلفن شبانه روزی: ۰۸۵-۱۸۸۶۲۰۲۱

FarmaSOS.com

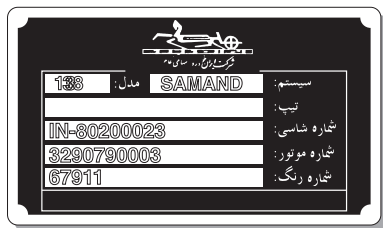

توجه :

چنانچه هر قطعه ای از سیستم خنک کننده (بغیر از در رادیاتور) باز یا تعویض شود، بایستی هواگیری مجددا توسط تعمیرگاههای مجاز مطابق دستورالعمل انجام پذیرد.

NOTE:

IF ANY PART OF COOLING SYSTEM IS OPENED OR REPLACED (EXCEPT RADIATOR CAP) THE AIR BLEEDING ACTION HAS TO BE PERFORMED BY AUTHORIZED SERVICE DEALER , ACCORDING TO THE INSTRUCTION.

توجه

باتری آلترناتور

ATTENTION
ALTERNATEUR

CAUTION
ALTERNATOR

ACHTUNG
WECHSELSTROM
GENERATOR

مهم

کابلشو مثبت باتری (قرمز رنگ) باید همیشه به قطب مثبت باتری وصل باشد. برای احتیاط از خسارت به آلترناتور هیچگاه آلترناتور نباید بدون اتصال به باتری کار نماید.

IMPORTANT
Le cosses + rouge doit toujours être branchée à la borne de la batterie. L'alternateur ne doit jamais tourner sans être connecté à la batterie, sous risque de détérioration.

IMPORTANT
The + red cable shoe should always be connected to the battery + terminal. To avoid damage the alternator should never turn without being connected to the battery.

SEHR WICHTIG
Der rote kabelschuh + muss immer am pluspol der Batterie angeschlossen sein. Der Wechselstromgenerator darf niemals drehen ohne An der Batterie angeschlossen sein. Bei Nichtbeachtung tung Zerstörungsgefahr.

5

IRAN KHODRO(CO)
NAAABC12XABC 1234567
1610 Kg
○ 2600 Kg
900 Kg
850 Kg

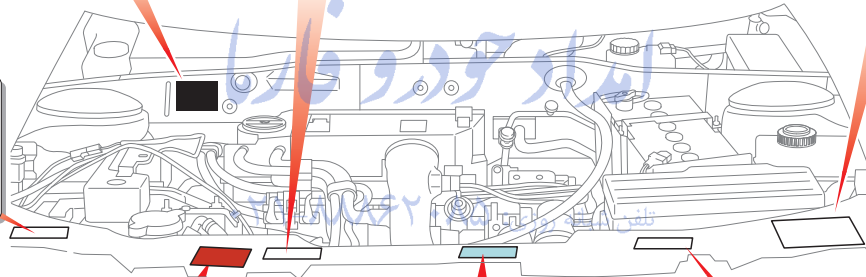

Pressurized cooling system

warning

توجه	از باز نمودن درب رادیاتور تا یک ساعت پس از خاموش شدن موتور اجتناب نمایید.
ATTENTION	CIRCUIT DE REFRIGERATION PRESSURISE NE PAS OUVRIR DANS L'HEURE SUIVANT L'ARRET DU MOTEUR
ACHTUNG	KÜHL SYSTEM UNTER DRUCK NACH ABSTELLEN DES MOTORS EINE STUNDE LANG NICHT OF FENEN
CAUTION	PRESSURIZED COOLING CIRCUIT DO NOT OPEN DURING ONE HOUR FOLLOWING ENGINE CUT-OFF
ATENCIÓN	CIRCUITO DE REFRIGERACION PRESURIZADO NO ABRIR DURANTE LA HORA QUE SIGUE LA PARADA DEL MOTOR
تنبیه	واحد و التبریه طالع الخط لا تقفوا في أثناء الساعة التي تتوقف المحرك

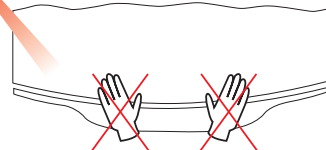

To close the engine cover, release it from a height of 30 centimeters and never exercise pressure with your hands on the engine cover

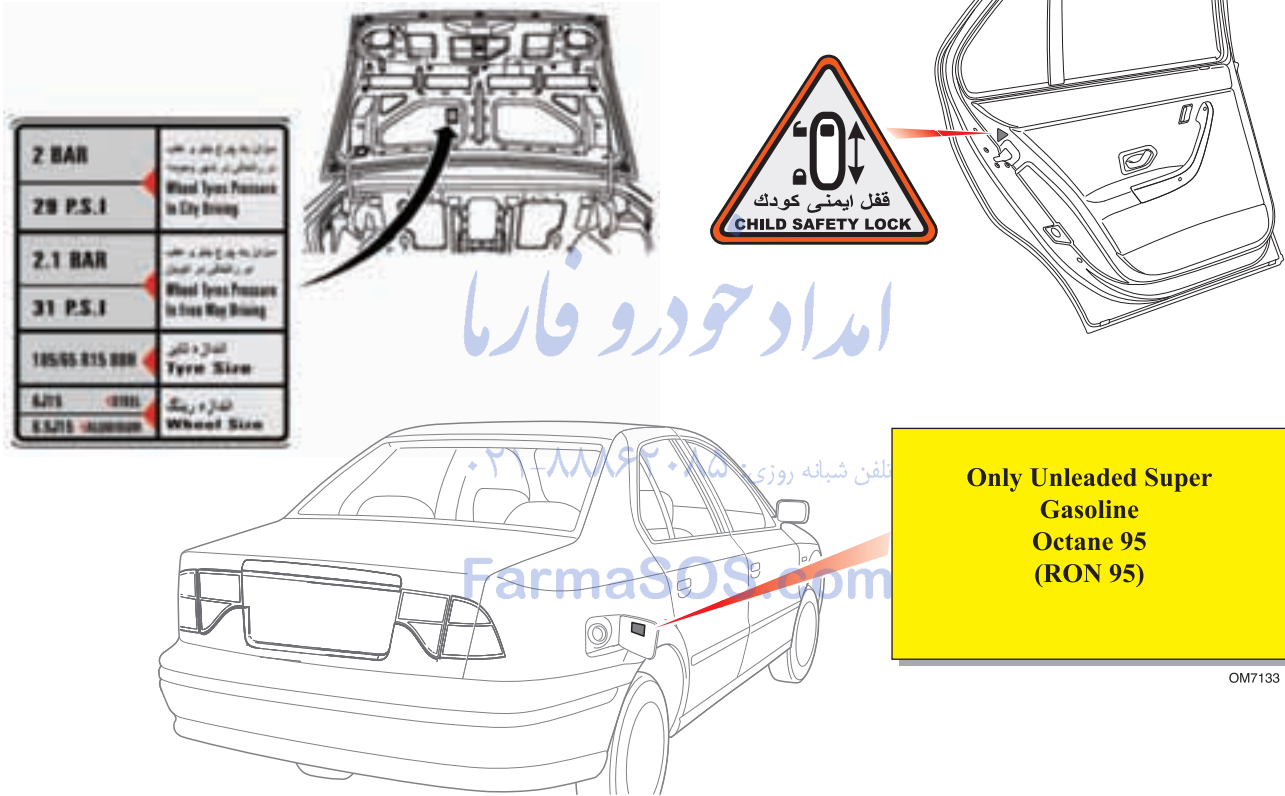

Identification Numbers

It is necessary to announce the corresponding number (IN) if you contact to the authorized dealer regarding the engine or the gearbox.

Vehicle Identification Number (VIN)

The plate with identification numbers stamped on its surface locates in the engine compartment on the upper partition panel.

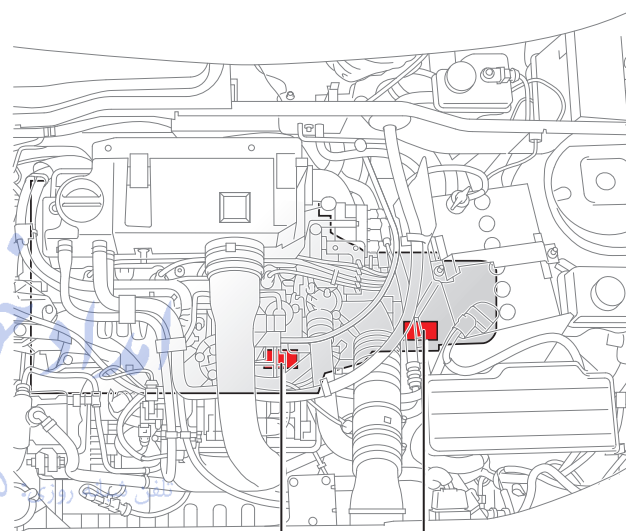
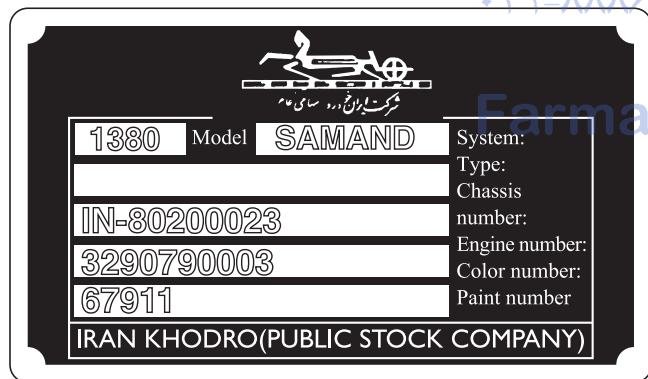

1. Engine number: Stamped Horizontally in front of the cylinder block
2. Gearbox number: Engraved on a plate in front of the gearbox housing

XU7JPL3	1.8i Lit
Cylinder volume (cm 3)	1761
Combustion Order	1-3-4-2
Slow rate of engine	850
Bore Dia	83. (mm)
Stroke	81.4 (mm)
Number of Cylinders	4
Number of Valves	8
Compression ratio	9.3: 1
Combustion System	Twin Static Ignition
Spark Plugs	SAGEM RFN58LZ
Spark Plugs Gap	0.9 +/- 0.05
Gear Box	BE 3/5
Max. Engine Power	6000 rpm 100 hp
Max. Torque	3000 rpm @ 153 NM
Octane Number	95
Max. engine power in gas mode**	85 horse power

Battery Type	SLI	
Battery Rating	66 Amp Hour	
Voltage	12 Volt	
Charging Circuit	Alternator	
RC (Reserve capacity)	110 mn	
Wheels and Tires		
Wheels	Aluminum* 6.5 J15-steel 6j15	
Tires	185/65R15	
Adjust		
Tire Press.	Front	Rear
Driving in City(urban areas)	29 psi/ 2 Bar/ 2.2 Bar**	29 psi/ 2 Bar 2.2 Bar**
Freeway Driving	31 psi/ 2.1 Bar/ 2.3** Bar	31 psi/ 2.1 Bar/ 2.3** Bar

* Upon Customer Request

** Samand Bi-Fuel Model

Capacities and Consuming Materials		Fuel Consumption	
Fuel Tank	66 Lit	Avg. Consumption (in urban and rural)	
Engine Oil * (with filter)	4/75 Lit Total Quartz 7000 10 W 40	Standard ECE R 101	8.5 Lit / 100 Km
	Or Total Quartz 5000	Avg. Consumption (at 90 Km/ h)	
Gear Box (Dry Type)	1/9 Lit	Standard ECE R 83	6.8 Lit / 100 Km
Cooling System(Dry Type)	6.6 Lit (40% antifreeze and 60% water)	Avg. Consumption (at 120 Km/h)	
Washer Reservoir	3.4 Lit	Standard ECE R 83	9.2 Lit / 100 Km
Hydraulic Fluid Reservoir	1.2Lit (ATF Dexron II- D)	Optimal fuel consumption is in 90Km/h.	
Brake Fluid	0.48 L Normal (DOT 4) Peugeot		
	0.52 L (ABS) (Bendix 55)		
Trunk capacity	500 Lit		
	350 Lit**		
*In the case of using oil total quartz 5000 renew it at 10000 Km			

FarmaSOS.com

Weights	
Approx. weight of the car without passenger with a full tank and without auxiliary equipments	1220 Kg
Maximum total weight	1610 Kg
Maximum weight with passenger and load	2600 Kg
Maximum load on the rear axis	850 Kg
Maximum load on the front axis	900 Kg

امداد خودرو فارما

تلفن شبانه روزی: ۰۲۱-۸۸۸۶۲۰۸۵

FarmaSOS.com



Overall length	4527 (mm)
Overall Width Exc. Mirrors	1720 (mm)
Overall Width Including Mirror	1903 (mm)
Overall Height	1460 (mm)
Wheel Base	2670 (mm)
Front overhang	866 (mm)
Rear overhang	964 (mm)
Wheels Track (Front)	1450 (mm)
Wheels Track (Rear)	1440 (mm)
Lock to lock Steering Wheel turns	3.1
Turning circle	11 m
Wheel Alignment Front (toe - in)	5-6 (mm)

Pollution Control System

In order to acquire Euro II standard approval, regarding polluting substances of the vehicle, following systems are used:

Engine: To obtain the above mentioned standard, it is necessary to use injection engine with up-to-date technology. The engine XU7JPL3 has been considered for the car.

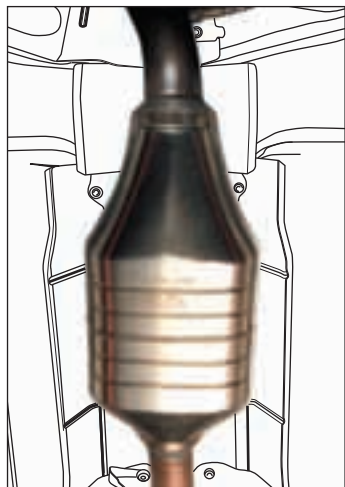

Oxygen Sensor: The car is equipped with oxygen sensor, which applies for measuring oxygen content in exhaust, adjusting combustion, increasing engine performance and reducing pollutant gas emission.

Catalytic Converter: Catalytic converter or Catalyst is used to react on exhausting pollutant to produce least pollution gases. Lead is of the most important factor in breaking or damaging catalyst. So it is necessary to use lead free gasoline.

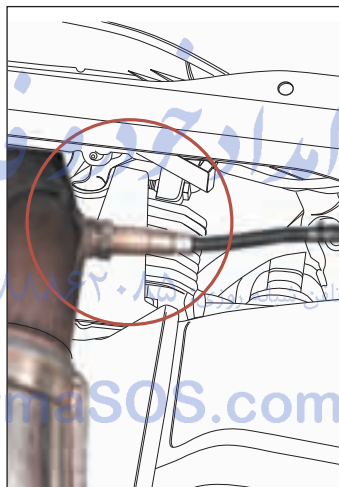

Control System of Gasoline Vapor Emission:

This system is installed to absorb gasoline vapors and to prevent emission to air and consequently reduces pollution and comprises the following items:
1-Fuel tank venting valves and fuel transmission pipes

Fuel tank is equipped with control system of gasoline vapor and fuel pipes material has been changed to prevent gasoline diffusion.

The vapor control valve is shown in the figure.

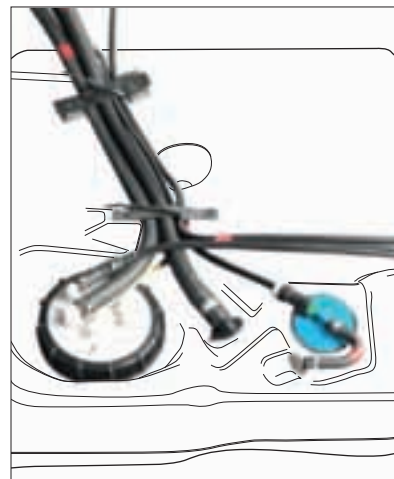

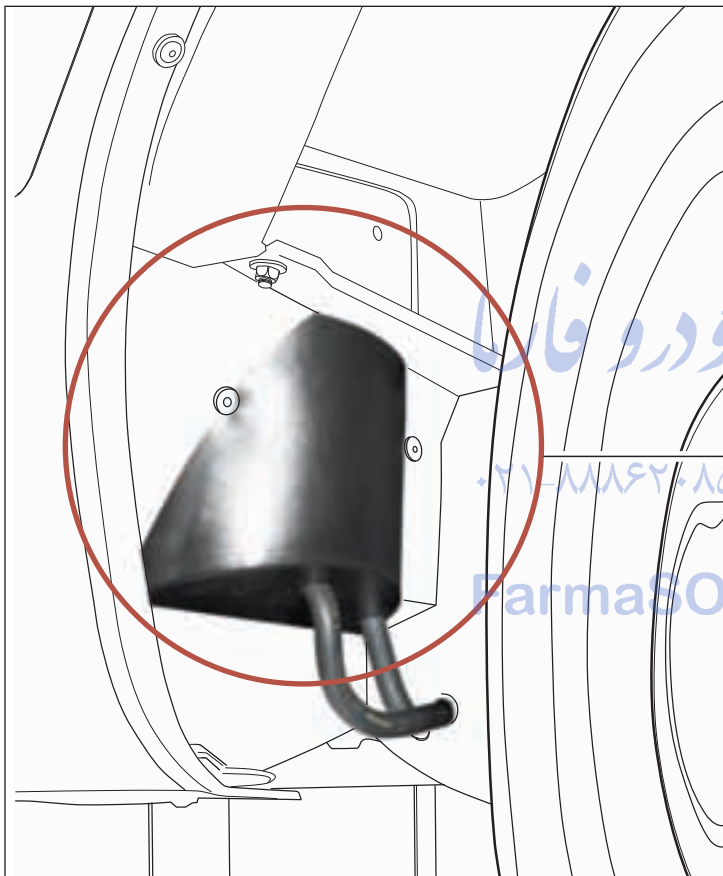

2. Absorbent Box

Absorbent box contains active carbon to absorb gasoline vapors, and to transmit vapors to the manifold of engine air intake.

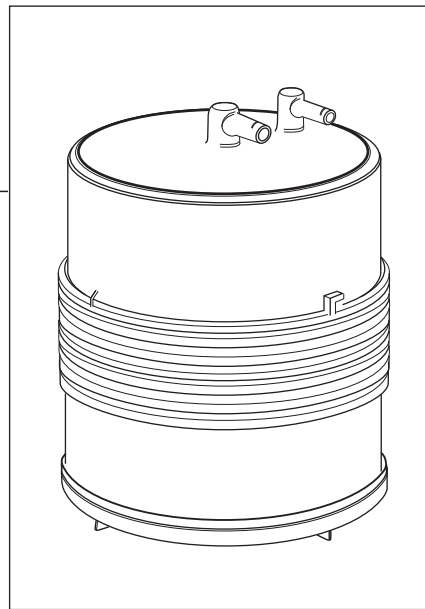

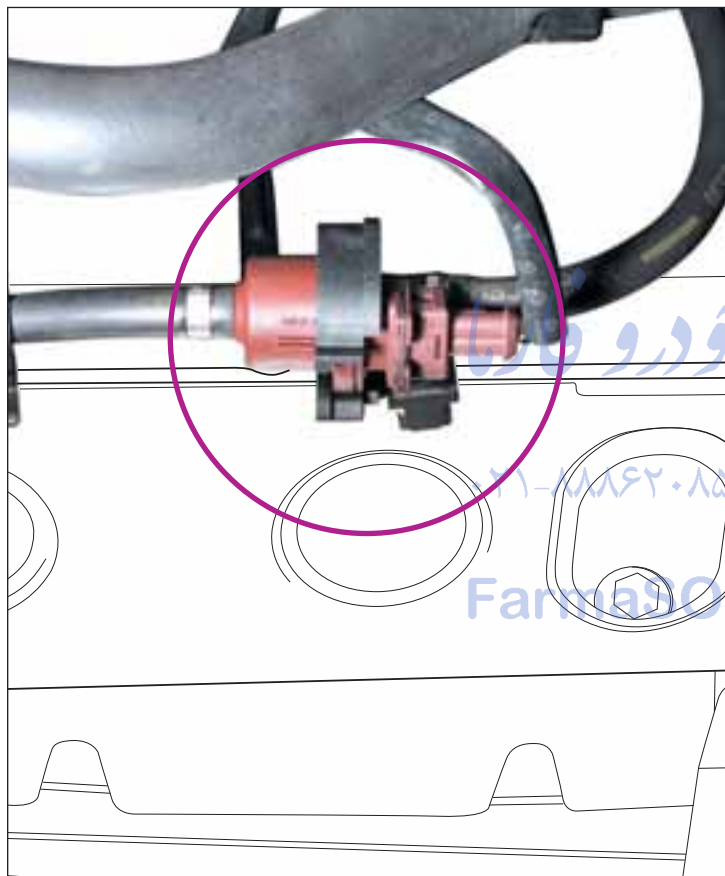

3. Purge Valve:

The valve located between absorbent box and air manifold to allow the gasoline vapor passage when the engine is on.

امداد خودرو فارما

تلفن شبانه روزی: ۰۲۱-۸۸۸۶۲۰۸۵

FarmaSOS.com

امداد خودرو فارما

6 INDEX

تلفن شبانه روزی: ۰۲۱-۸۸۸۶۲۰۸۵



INDEX

A	
Absorbent Box	126
Adjusting Headrest Height.....	12
Adjusting Instrument Panel Dimmer.....	27
Adjusting Lumbar Support.....	11
Adjusting Seat Height.....	12
Adjusting Steering Wheel.....	17
Air Bag Alarm System.....	60
Air Bag Inspection.....	76
Air Conditioning.....	22
Air Distribution Adjustment.....	21
Air Flow Adjustment Lever.....	21
Alarm System (Normal position).....	37
Alarm System General Information.....	41
Anti Freeze.....	85
Anti-Lock Braking System.....	73
Anti-Lock Braking Warning System.....	59
Audio System.....	30
Audio-Video Alarm System Specifications.....	34
Audio-Visual Alarm System Specifications.....	34
Automatic Engine Troubleshooting Device.....	58
Automatic Lock.....	39
B	
Background Light.....	38
Backrest Power Adjustment.....	11
Battery Charging.....	58
Battery Detaching.....	88
Battery Replacement (Knife Blade).....	10
Battery Replacing.....	88
Battery, Common Problems.....	89
Body Protection.....	95
Booster Cable Usage.....	100
Booster Cable, Connecting.....	101
Brake Fluid Replacement.....	81
Brake Fluid.....	86
Brake Pads.....	59
Brake System Alarm.....	59
Brakes.....	86
Breaking-in.....	62
Buttons' Function.....	34
C	
Car Finder.....	39
Center & Side Vents.....	22
Change of Language.....	50
Checking Oil Level.....	84
Checking the Brake Fluid.....	86
Checking the Coolant.....	85
Checking the Hydraulic Fluid.....	87
Child Safety Locks.....	8
Cleaning the Bodywork.....	94
Cleaning the Underneath.....	94
Clock Setting.....	48
Closing the Hood.....	82
CNG Pointer.....	60
Cold Weather.....	62
Contrast.....	50

Coolant Temperature Gauge.....	56
Cubby Box.....	26
Cup Holder.....	28

D

Date Adjustment.....	49
Default Settings.....	51
Demisting/Defrosting.....	23
Detective Tires.....	93
Digital Clock.....	29
Digital Display Panel (Trip Recorder).....	56
Direction Indicators.....	57
Direction Indicators.....	68
Distance Display Screen.....	42
Distance Recorder Reset Button.....	56
Door Light.....	113
Doors Open.....	59
Driver Information Display Menu.....	43
Driver Safety Belt.....	59

E

Electrical Mirrors, Adjusting.....	18
Electronic Brake Force Distribution.....	74
Engine Compartment Fuse Box.....	106
Engine Compartment Parts	83
Engine Oil Fill	84

F

Filling the Radiator.....	85
Filling, Windshield Washer Reservoir.....	90

First Aid Kit.....	16
Flashers.....	69
Foot Brake Servo Assistance.....	72
Four Digit Code Number Changing.....	46
Four Digit Code Number, Timing.....	47
Front Ashtray.....	25
Front Courtesy Light.....	114
Front Courtesy Ligh.....	24
Front Direction Indicators.....	110
Front Fog Light.....	112
Front Fog Lights.....	57
Front Fog Lights.....	69
Front Seat Belts Height.....	14
Front Seat Belts, Notice.....	15
Front Towing Ring.....	102
Front Towing.....	103
Fuel Cut-Off Switch.....	67
Fuel Filler Cap.....	67
Fuel Filler Flap.....	67
Fuel Gage.....	56
Fuse Box.....	104
Fuse Specification.....	106
Fuses.....	104

G

Gasoline Vapor Emission, Control System.....	125
Gear Positions.....	65
Glove Box Opening.....	28
Glove Box.....	28

H		K	
Handbrake.....	72	Key Set.....	7
Hazard Warning Triangle.....	98	Kilometres Adjustment.....	43
Head Position on Headrest.....	12		
Headlamp Adjustment.....	70	L	
Headlamp Dipped Beam.....	109	Lighting Control Switch.....	68
Headlamp Main Beam.....	109	Locking/Unlocking.....	8
Headlight Dipped Beam.....	57	Low Fuel Level Warning.....	60
Headlight Main Beam.....	57		
Headlight Main/Dipped Beams.....	68	M	
Heating & Ventilation.....	20	Main Menu.....	41
High Coolant Temperature.....	60	Map Reading Light Timer (RLT).....	38
High Mounted Stop Light.....	112	Map Reading Light.....	114
Horn.....	70	Map Reading Light.....	24
Hydraulic Steering.....	87	Maximizing Cooling & Air Flow System.....	23
		Maximizing Heating System.....	23
I		Mirror, Manual Adjusting.....	18
Identification Number.....	120	Mirrors.....	95
Immediate Stop Command.....	58	Moving Seat Forward/Backward.....	11
Instrument Panel.....	54		
Interior Air Recirculation.....	22	N	
Interior Equipment.....	32	Number Plate Light.....	113
J		O	
Jack Knife.....	7	Oil Filter Screen.....	42
Jacking.....	99	Oil Pressure.....	58
		Opening the Hood.....	82

64	Replacing Fuses.....
14	Replacing the Coolant
93	Replacing the Wiper
93	Reverse Gear Warn

.....۲۱-۸۸۸۶۲۰۸۵	S تلفن شبانه روزی:
.....27	Safety in the Garage
.....25	Screen Washer.....
.....114	Seat Belts Safety T
.....24	Security Code Setti

114	Seat Belts Safety T
24	Security Code Setti

Rear Window.....	95
Rear-View Mirror.....	18
Releasing the Belt.....	14
Releasing Trunk Lid Lever & Cable.....	9
Remote Keyless Entry System.....	7
Removing Aluminums Sport Rings.....	99
Removing Tar Spots.....	95
Removing Wiper Blades.....	90
Replacing Bulbs.....	107
Replacing Fuses.....	104
Replacing the Coolant.....	81
Replacing the Wiper Blades.....	91
Reverse Gear Warning System.....	65
Reverse Lamp.....	111
Routine Services.....	81

Safety in the Garage.....	80
Screen Washer.....	71
Seat Belts Safety Tips.....	13
Security Code Setting.....	45
Shipping by Carrier.....	103
Shock Sensor Display.....	45
Side Direction Indicators.....	109
Side Lamp Mirror.....	115
Side Repeater Lights.....	110
Side Windows.....	19
Single Wipe.....	71
SLI Battery.....	89

Spare Wheel and Tools.....	98	Trunk Lid Release Handle.....	27
Spare Wheel.....	98	Trunk Light.....	115
Speedometer.....	56	U	
Start Switch.....	63	Unlocking the Steering Wheel.....	63
Starting the Engine (Battery Discharged).....	100	V	
Starting the Engine.....	62	Vanity Mirror Light.....	115
Sun Visor Vanity Mirror.....	18	Vehicle Identification Number.....	120
Sun Visor.....	26	W	
Supplemental Restraint System.....	75	Warming Up the Engine.....	62
Switches.....	19	Warning Alarm.....	68
System Specifications.....	65	Warning Message System.....	35
T		Wearing Safety Belts.....	14
Tachometer.....	56	Window and Mirrors.....	95
Technical Specifications.....	66	Windshield Wiper.....	71
Temperature Adjustment.....	21	Windshield.....	95
Temperature Setting.....	44	Wiper Blades.....	95
Theft-Deterrent Activation Time.....	36		
Theft-Deterrent System (Shock Sensor).....	45		
Theft-Deterrent System, Resetting.....	40		
Theft-Deterrent System.....	36		
Tire Wear Indicators.....	93		
Tires' Pressure.....	93		
Tools.....	98		
Towing Car, Manual Gear Box.....	102		
Towing Car.....	102		
Troubleshooting the System.....	66		
Trunk Lid Key.....	29		
Trunk Lid Lock.....	9		